

*New Hampshire*  
**DOT**  
*Department of Transportation*

Maps and data sets are not guaranteed to be free from errors and omissions. Data is in a constant state of update and correction by various groups and agencies. Information displayed on this map is the best available at the time of publication.

# 2022 Nodal Reference Bookmap

## LEGEND



NHDOT will accept crash locations based on the State of NH Uniform Police Traffic Accident Report.

Crash occurred on:

**Option 1**     Street Address  
                   123 Main Street

**Option 2**     Route No and/or     Distance from             NESW             Intesecting Road, Bridge,  
                   Street name             Intersecting Street                                     Town/County line  
                   Main Street                     500                     E                     Oak Street

**Option 3**     First Node                     Distance from First Node                     Second Node  
                   515                                     212                                     632

**Option 4**     Route No and/or             Mile Marker on Interstate Only     NESW             Mile (Marker)  
                   Street name  
                   189S                                     700 feet                     S                     36.8

**Option 3 – Example**

Street Name                     Loudon Road  
First Node                             803  
Distance from First Node             318 Ft  
Second Node                             813



# GRANTHAM

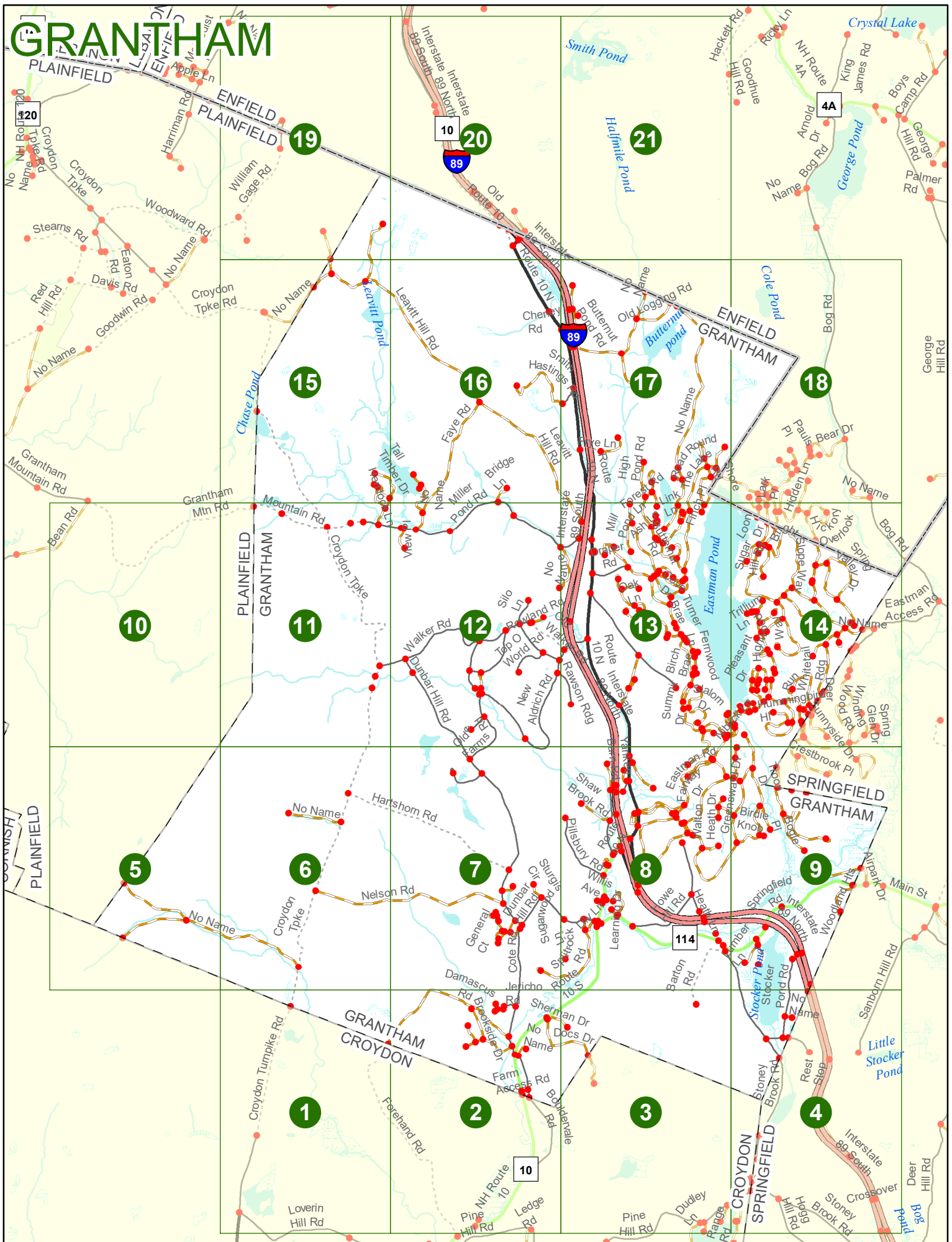

# GRANTHAM

Match to Page 6

Croydon Tpke

6014

GRANTHAM  
CROYDON

Damascus Rd

6075

0

Match to Page

Croydon Turnpike Rd

Forehard Rd

Match to Page

2

# 1

0070

0068

Croydon Turnpike Rd

Loverin Hill Rd

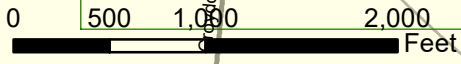

Match to Page 0

0069

# GRANTHAM

Match to Page 7

Match to Page 1

Match to Page 3

# 2

GRANTHAM  
CROYDON

0 500 1,000 2,000 Feet

Match to Page

0

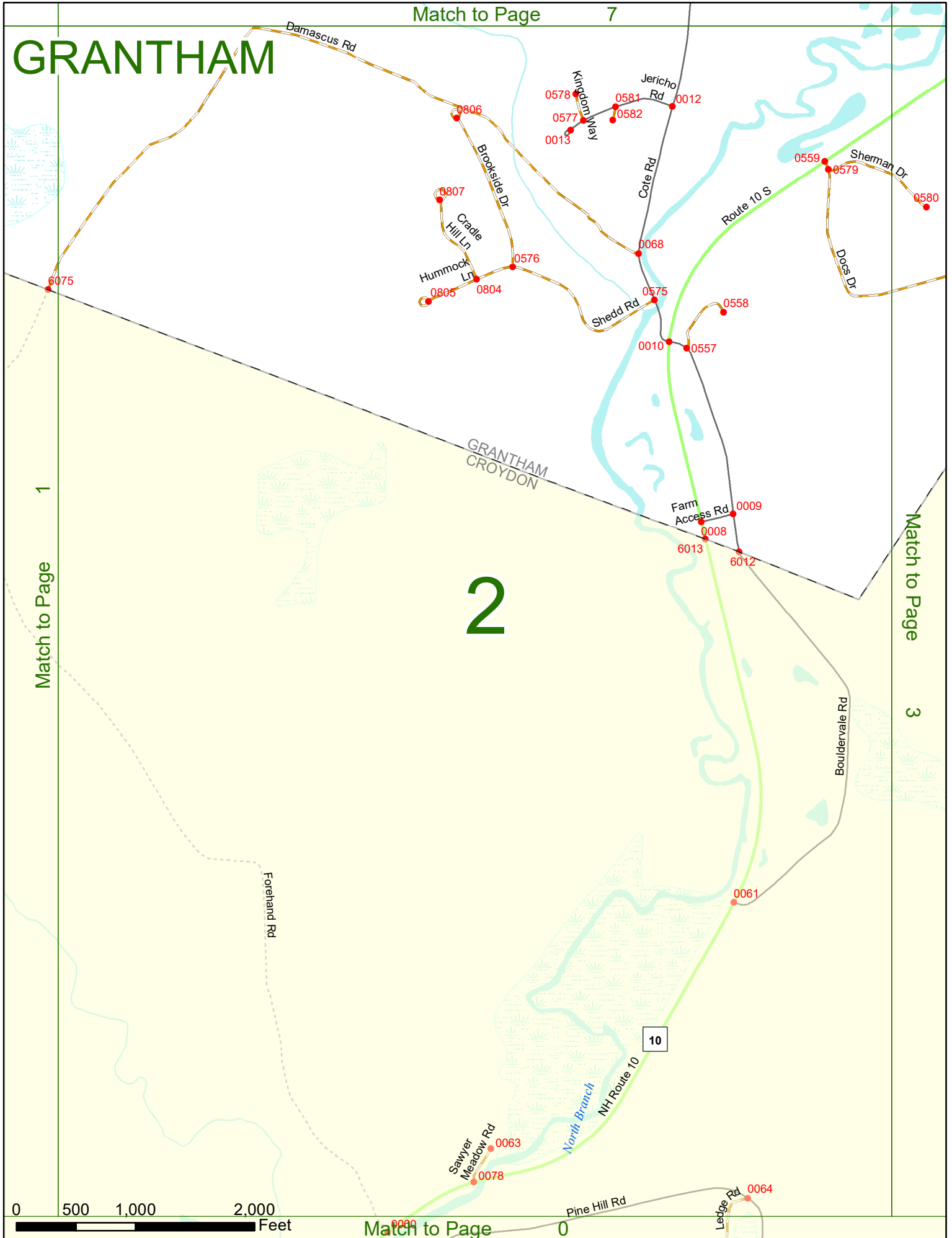

# GRANTHAM

Baton Rd.  
0005

Route 10 S  
10

Sherman Dr.  
0580

Docs Dr.  
6308

GRANTHAM  
CROYDON

0572

2

Match to Page

# 3

Match to Page

4

Bouldervale Rd

Cranberry Pond

0 500 1,000 2,000 Feet

Match to Page

0

Dudley Ln 0181  
Loon Ln 0176  
Main Camp Rd 0178  
Range Rd 0196  
0179  
0197  
0066

Lake Coniston

Pine Hill Rd

# GRANTHAM

Match to Page 9

Match to Page 3

Match to Page 0

## 4

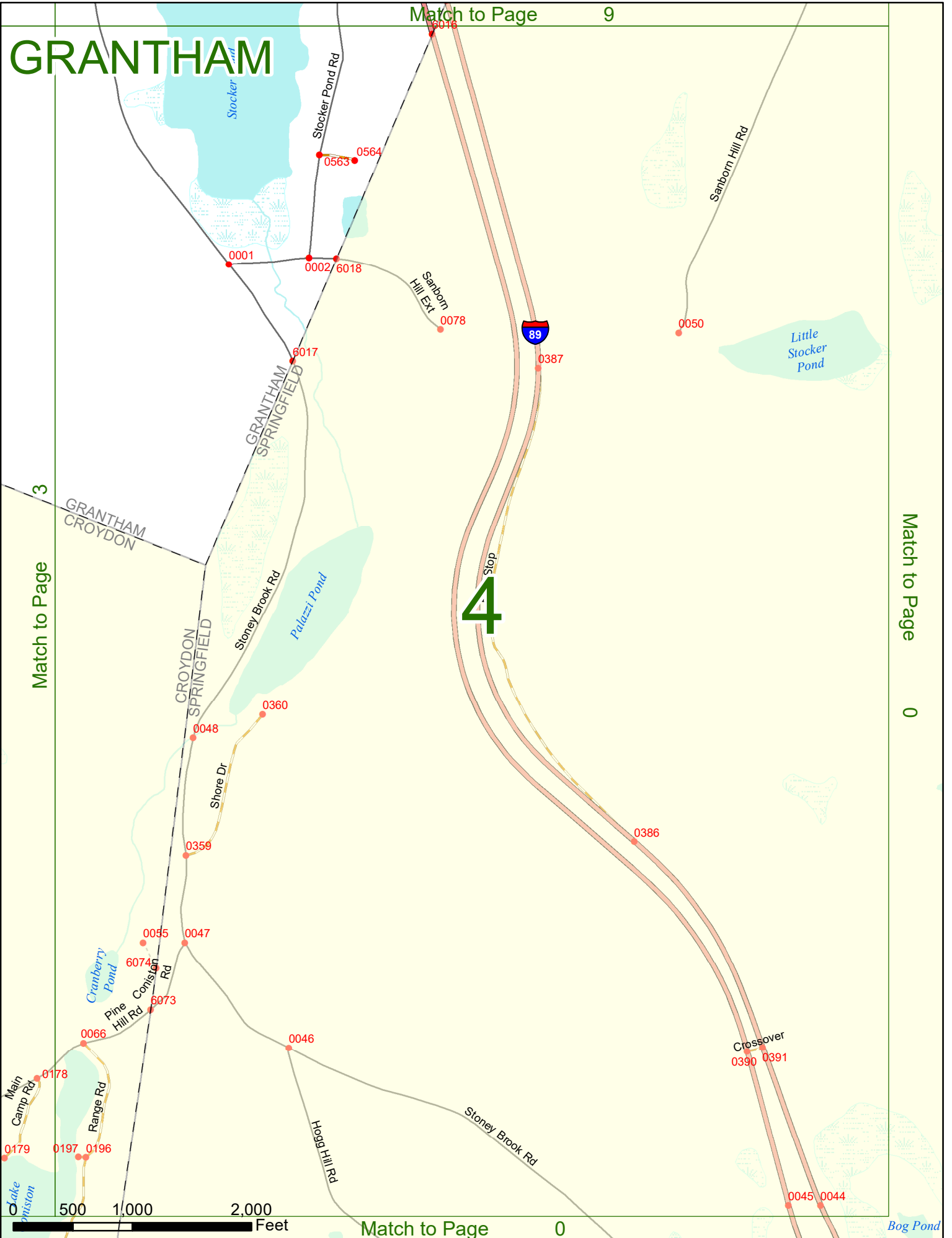

Match to Page 0

Bog Pond

# GRANTHAM

Match to Page 0

Match to Page 6

# 5

PLAINFIELD  
GRANTHAM

PLAINFIELD  
CROYDON

GRANTHAM  
CROYDON

6298

0544

0543

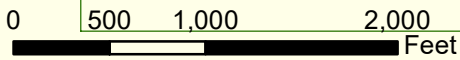



# GRANTHAM

# 6

Match to Page 5

Match to Page 7

Croydon Tpke

Hartshorn Rd

Nelson Rd

Croydon Tpke

0548

0547

0087

0014

0542

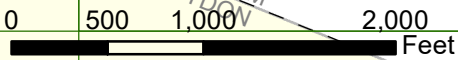

GRANTHAM  
CROYDON

GRANTHAM  
CROYDON

# GRANTHAM

Match to Page 12

New Aldrich Rd

Olde Farms Rd

0086

0084

0083

Meadowbrook Rd

Dunbar Hill Rd

Hartshorn Rd

6

Match to Page

7

0073

Pillsbury Rd

Match to Page

8

0082

0573

0572

0549

Sturgis Cir

0550

Nelson Rd

0088

Wintercroft  
Barister  
Paultn

0796

0556

0794

0795

Corbin  
Cir

0790

0792

0793

Hatties  
Ln

0555

0555

0584

0791

0583

0583

0581

0583

0583

0583

0583

0583

0583

0583

0583

0583

0583

0583

0583

Cape Rd

0551

Sugarwood Ln

0552

0571

Splitrock Rd



Match to Page 2

North Branch

# GRANTHAM

Match to Page 13

Match to Page 7

Match to Page 9

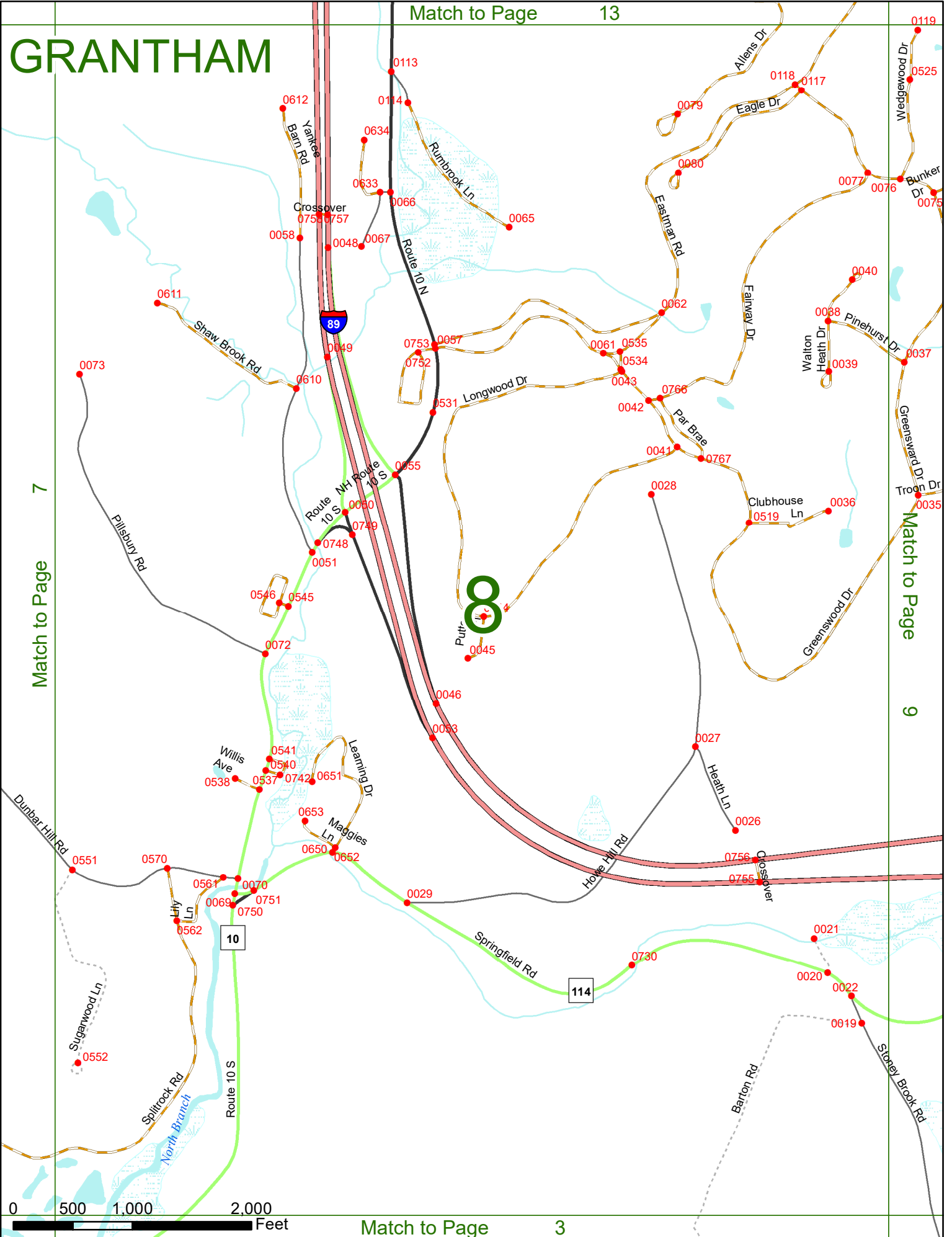

0 500 1,000 2,000 Feet

Match to Page 3

# GRANTHAM

Match to Page 14

8

9

Match to Page 0



Match to Page 4

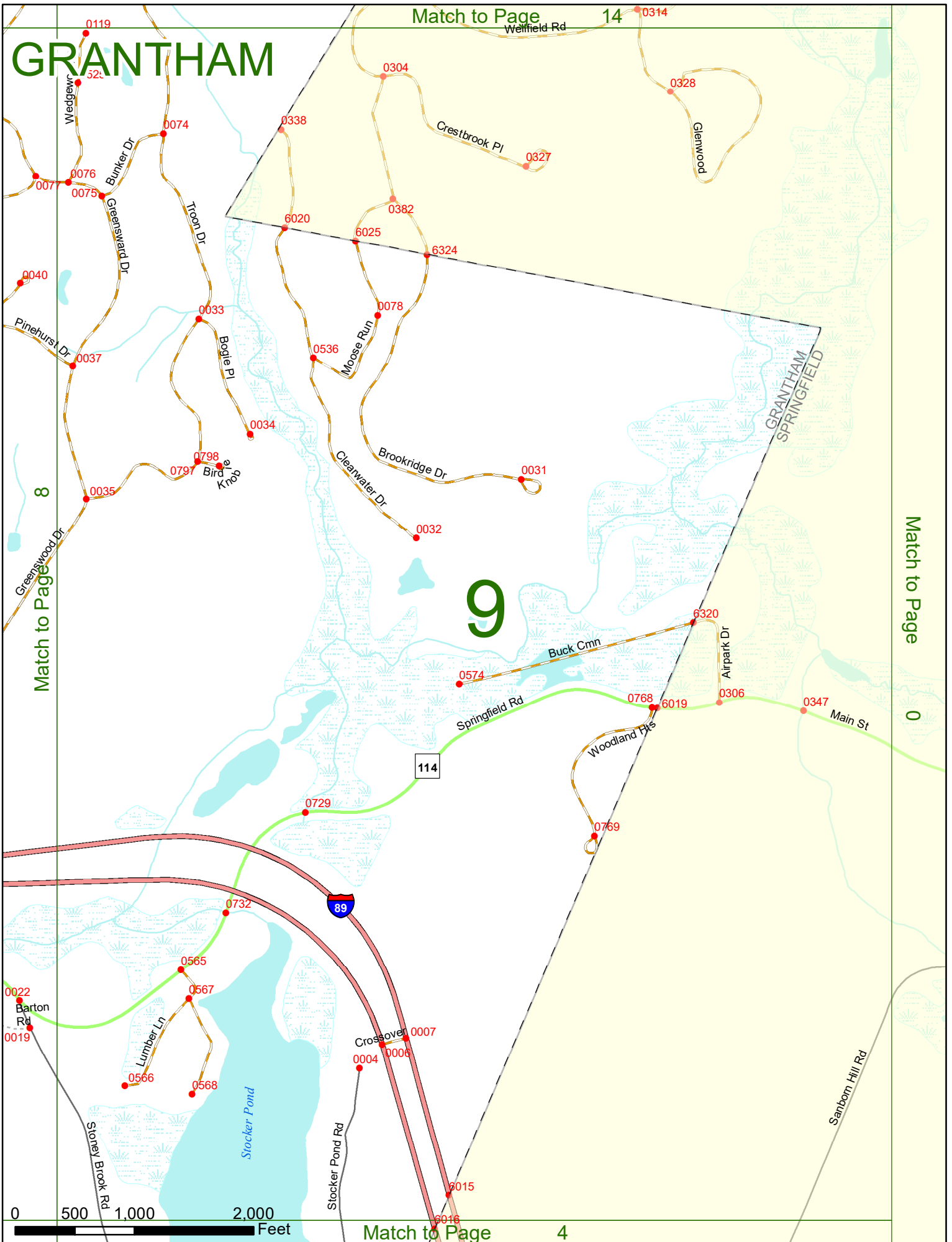

# GRANTHAM

Match to Page 0

Bean Rd

Grantham Mtn Rd

0115

0

Match to Page

# 10

Match to Page

11

0 500 1,000 2,000 Feet

Match to Page 5

PLAINFIELD  
GRANTHAM

# GRANTHAM

Grantham M... Rc

Match to Page 15

10

Match to Page

PLAINFIELD  
GRANTHAM

# 11

Match to Page

12

0 500 1,000 2,000 Feet

Match to Page

6

Lily Pond

0119

0701

0731

Mountain Rd

0233

0776

0520

0643

Miller Pond Rd

0202

0621

Tell Timber Dr

View Pt

Mill Pond

Croydon Tpke

0090 Walker Rd

0739

0735

Croydon Tpke

# GRANTHAM

Match to Page 16

# 12

11

Match to Page

Match to Page

10

7

Match to Page 7

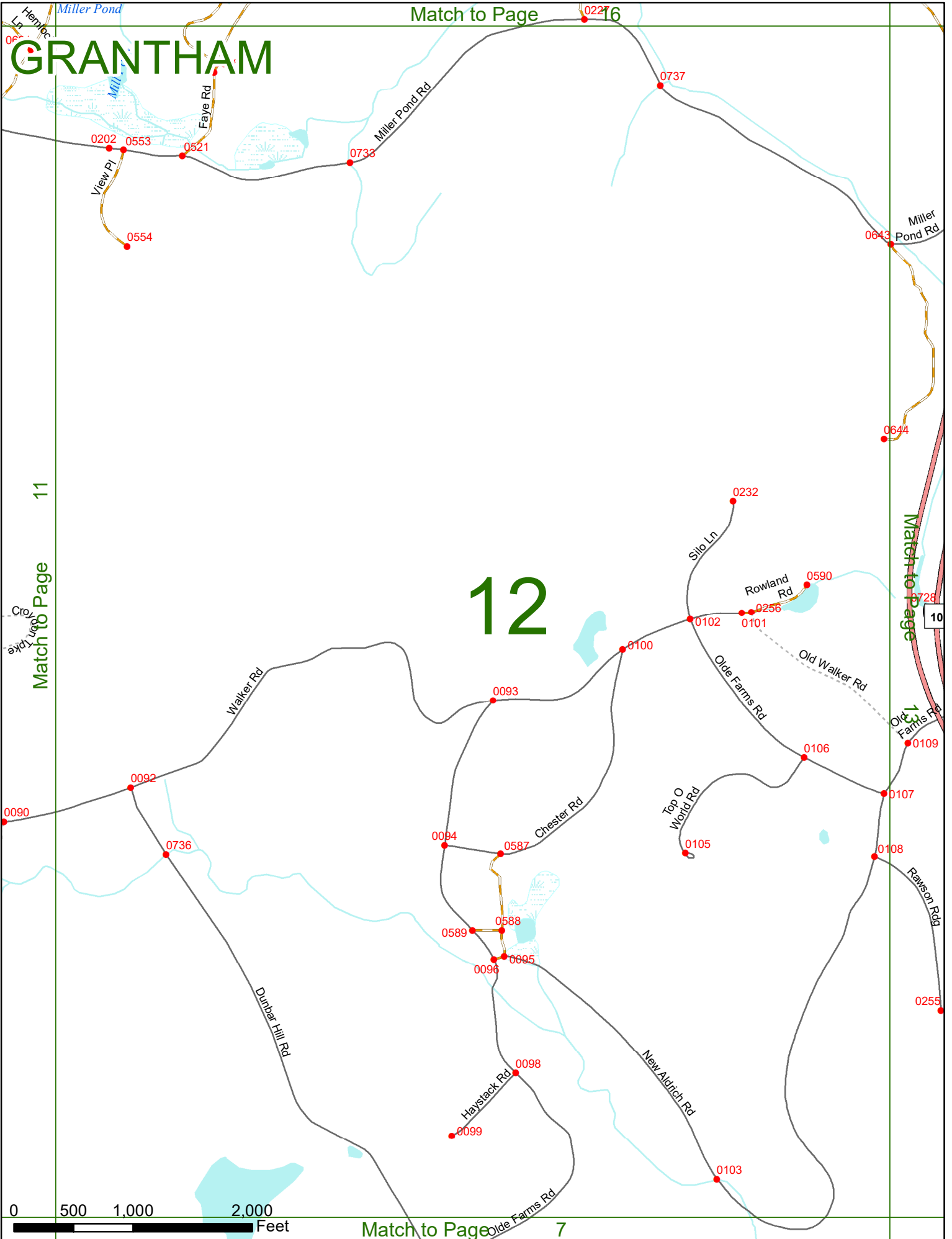
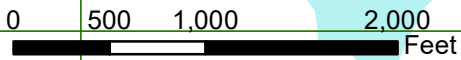

# GRANTHAM

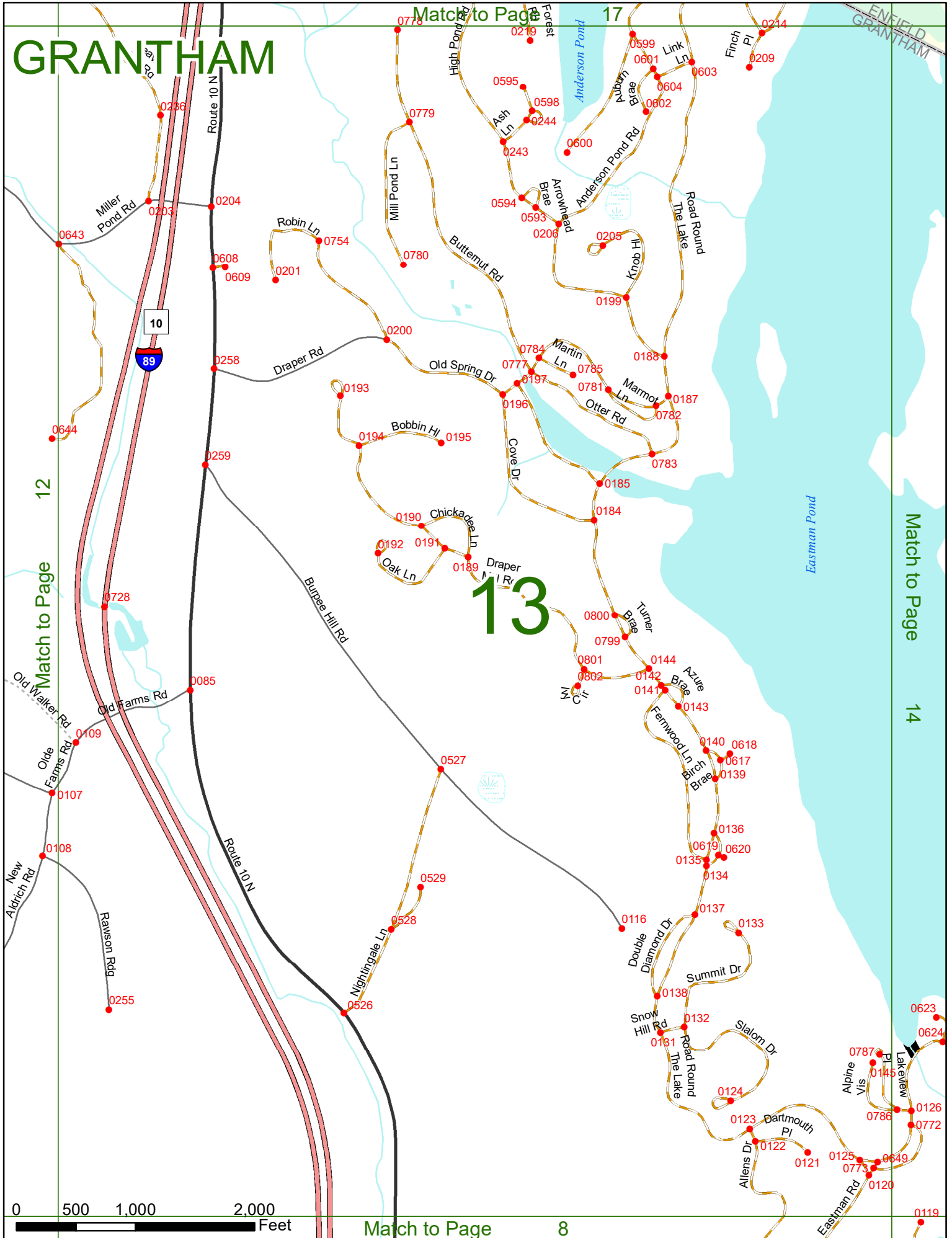

Match to Page 8



# GRANTHAM

Match to Page 18

Match to Page 13

Match to Page 0

# 14

Match to Page 9

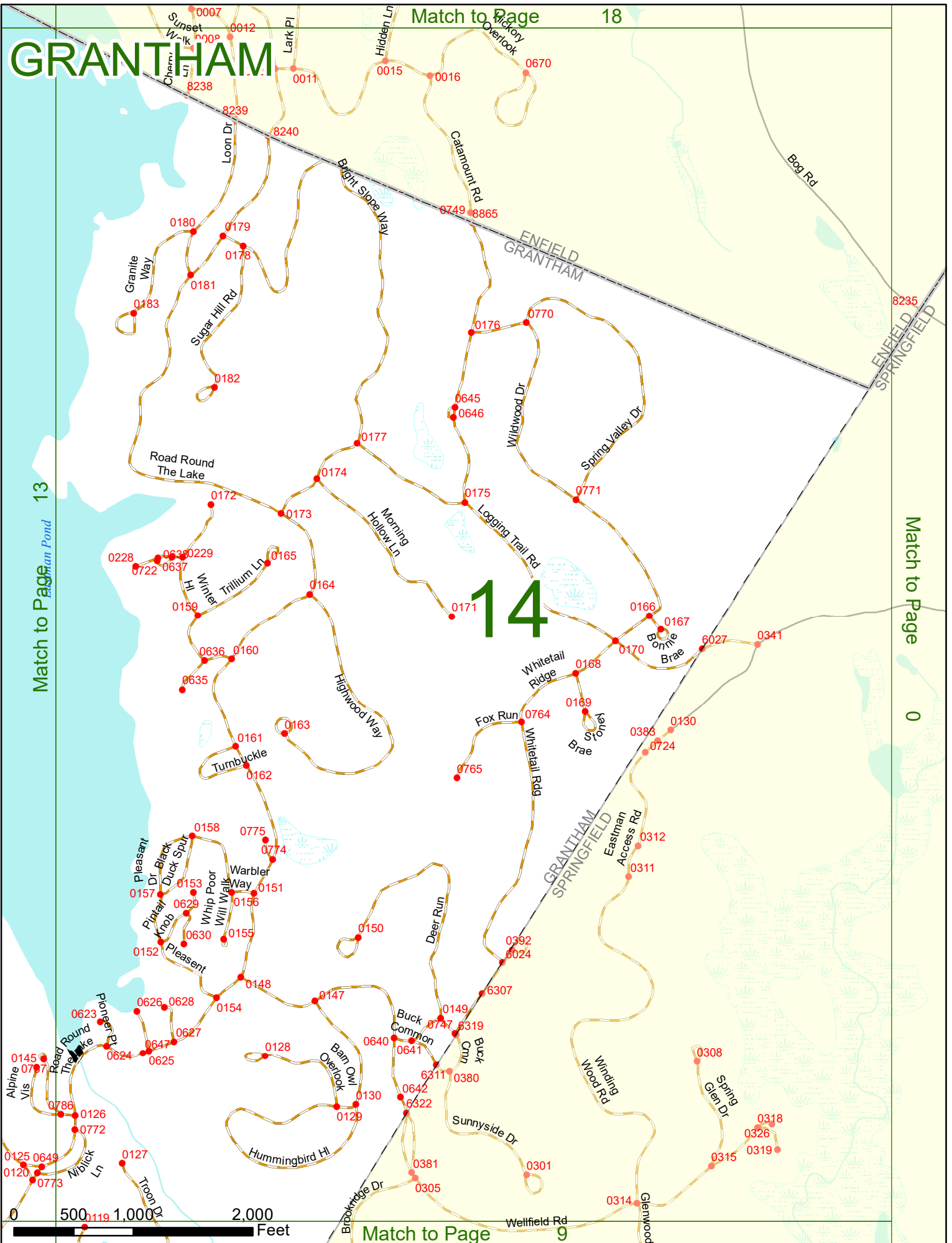

# GRANTHAM

Match to Page 19

Match to Page 0

Match to Page 16

# 15

0 500 1,000 2,000 Feet  
Granatham Mill Rd

Match to Page

11

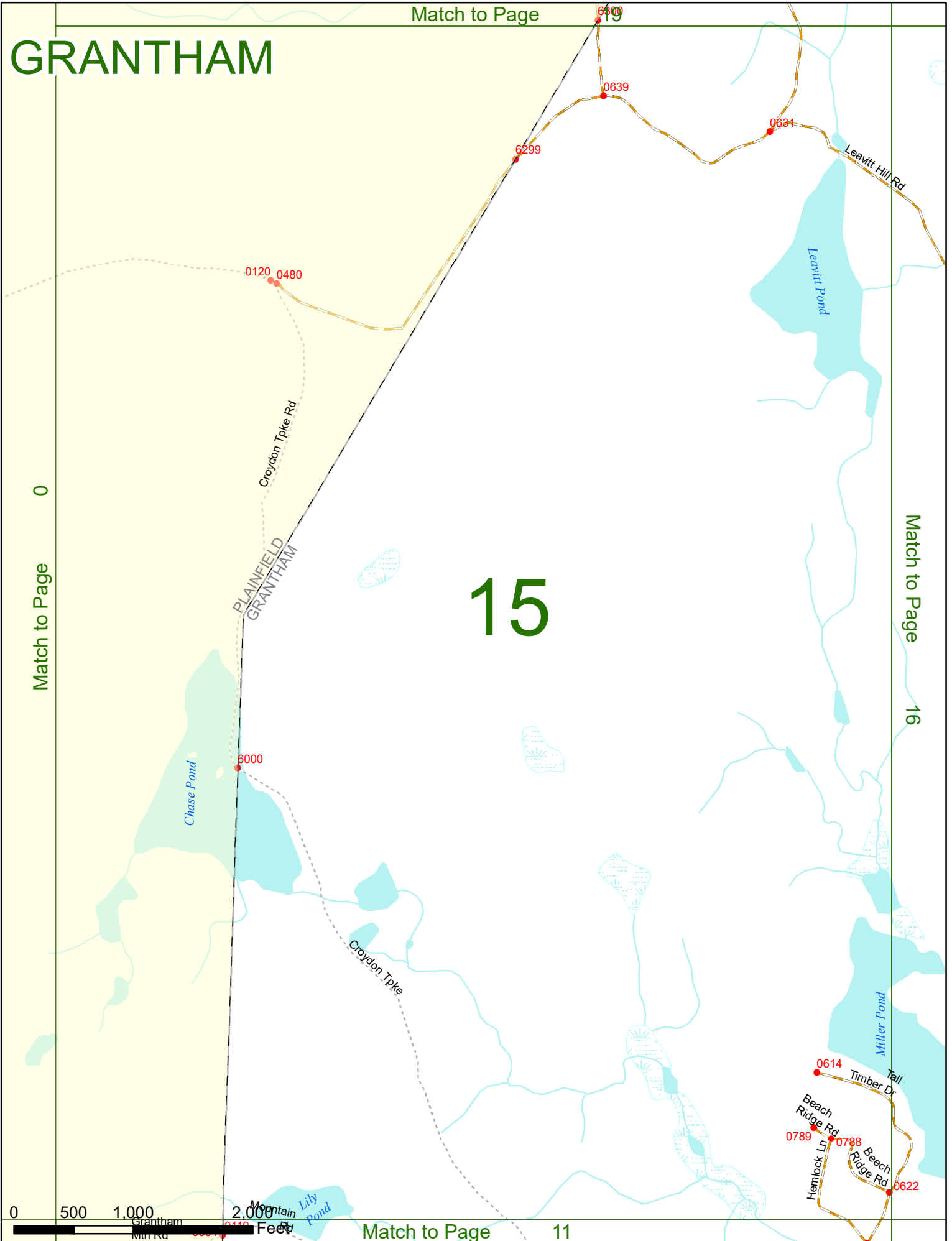

# GRANTHAM

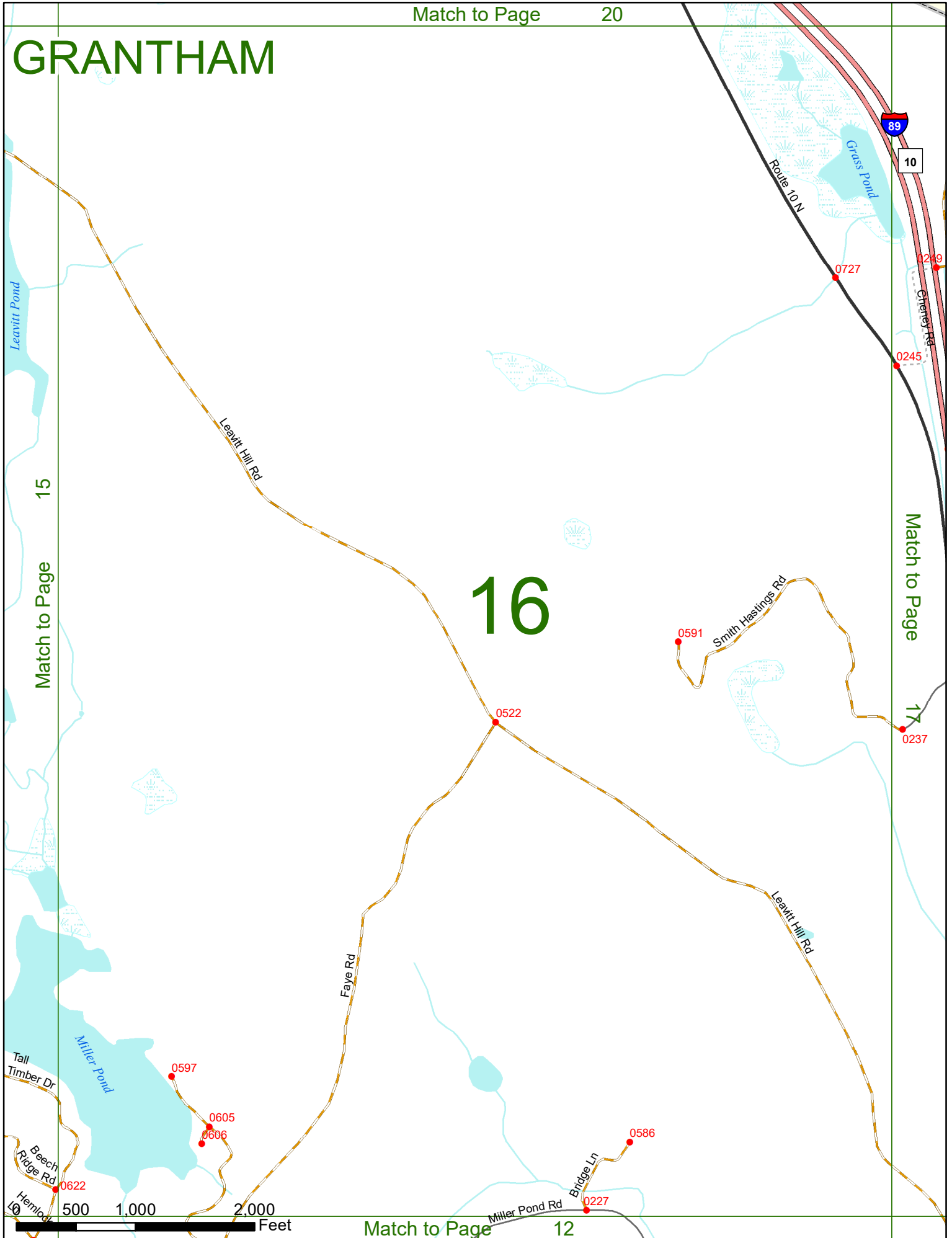

15

Match to Page

# 16

Match to Page

17



# GRANTHAM

ENFIELD  
GRANTHAM

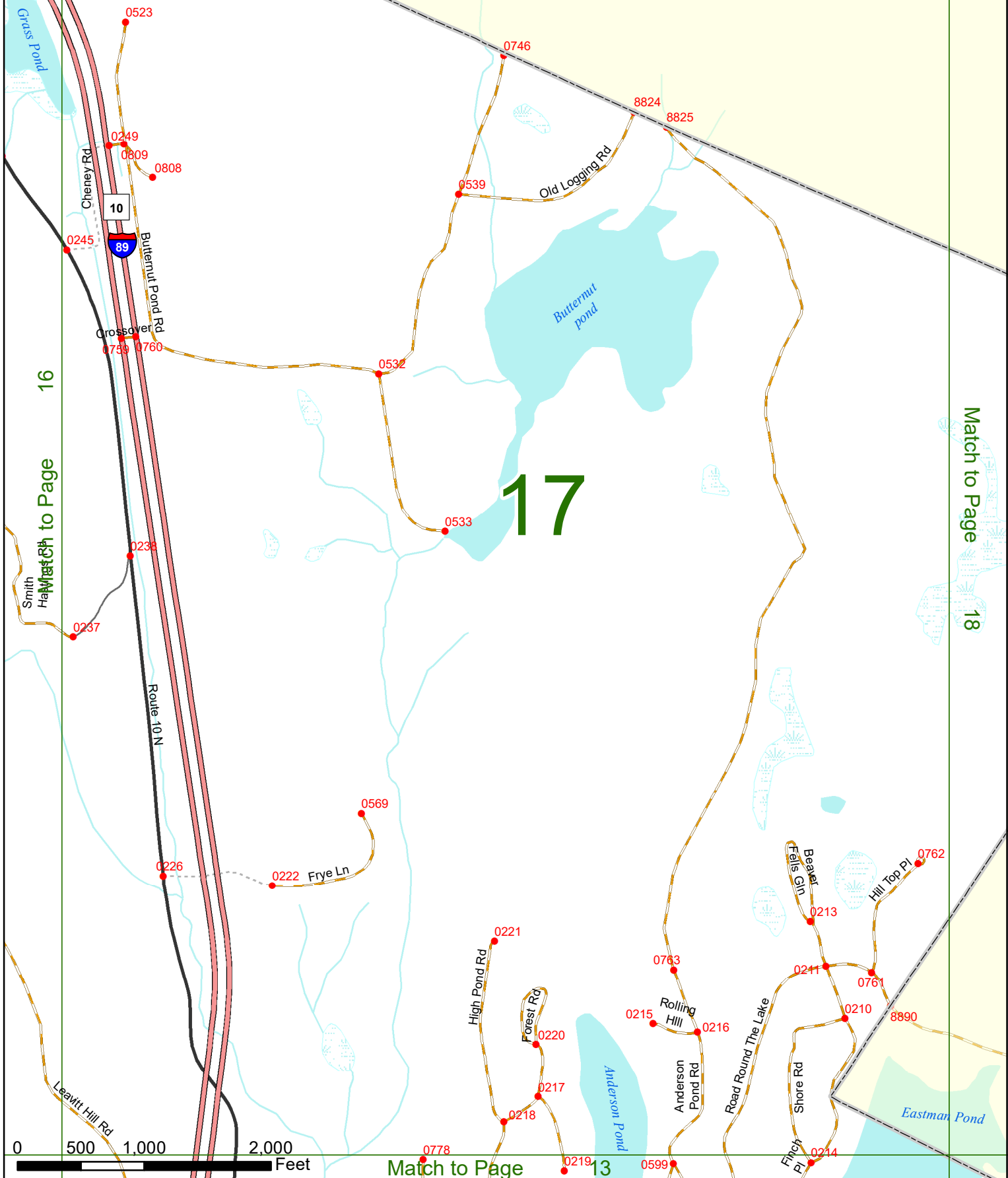

16

Match to Page

# 17

Match to Page 18



Match to Page 13

# GRANTHAM

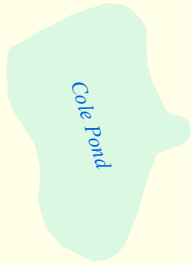

17

Match to Page

# 18

Match to Page

0

GRANTHAM  
ENFIELD

Bog Rd

Bog Rd

Bear Dr

Road Round The Lake

Eastman Pond

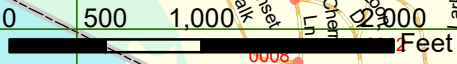

Match to Page

14

0762

0018

0675

0674

0003

0708

0452

0672

0673

0004

0451

0669

0454

0006

0005

0453

0010

0614

0007

0013

0008

0665

0664

Sunset Walk

Chert Ln

Log Ln

Lark Pl

Hidden Ln

Hickory Overlook

0

500

1,000

2,000

3,000

Feet

# GRANTHAM

0450

0

Match to Page

0690

8245

0206

8229

# 19

0416

ENEFIELD  
PLAINFIELD

Match to Page

20

William Gage Rd

ENEFIELD  
GRANTHAM

Woodward Rd

0136

0135

PLAINFIELD  
GRANTHAM

0474

0632

6300

0 500 1,000 2,000 Feet

Match to Page

15

# GRANTHAM

19

Match to Page

Match to Page

21

# 20

Old Route 10

10



0032

0209

Old Route 10

Crossover

0765

0764

0029

0030

0457

8230

8231

8232

8800

0723

0751

8887

0252

0253

Route 10 N

10



Smith Pond

ENEFIELD  
GRANTHAM

0632



# GRANTHAM

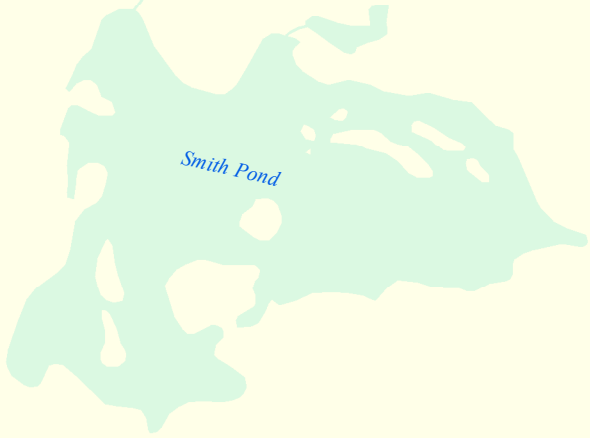

Smith Pond



Halfnote Pond

# 21

Hackett Rd

0038

Goodhue Hill Rd

0039

20

Match to Page

Match to Page

0

