

New Hampshire
DOT
 Department of Transportation

Maps and data sets are not guaranteed to be free from errors and omissions. Data is in a constant state of update and correction by various groups and agencies. Information displayed on this map is the best available at the time of publication.

2022 Nodal Reference Bookmap

LEGEND



NHDOT will accept crash locations based on the State of NH Uniform Police Traffic Accident Report.

Crash occurred on:

Option 1 Street Address
 123 Main Street

Option 2 Route No and/or Distance from NESW Intesecting Road, Bridge,
 Street name Intersecting Street Town/County line
 Main Street 500 E Oak Street

Option 3 First Node Distance from First Node Second Node
 515 212 632

Option 4 Route No and/or Mile Marker on Interstate Only NESW Mile (Marker)
 Street name
 189S 700 feet S 36.8

Option 3 – Example

Street Name Loudon Road
First Node 803
Distance from First Node 318 Ft
Second Node 813



STRAFFORD

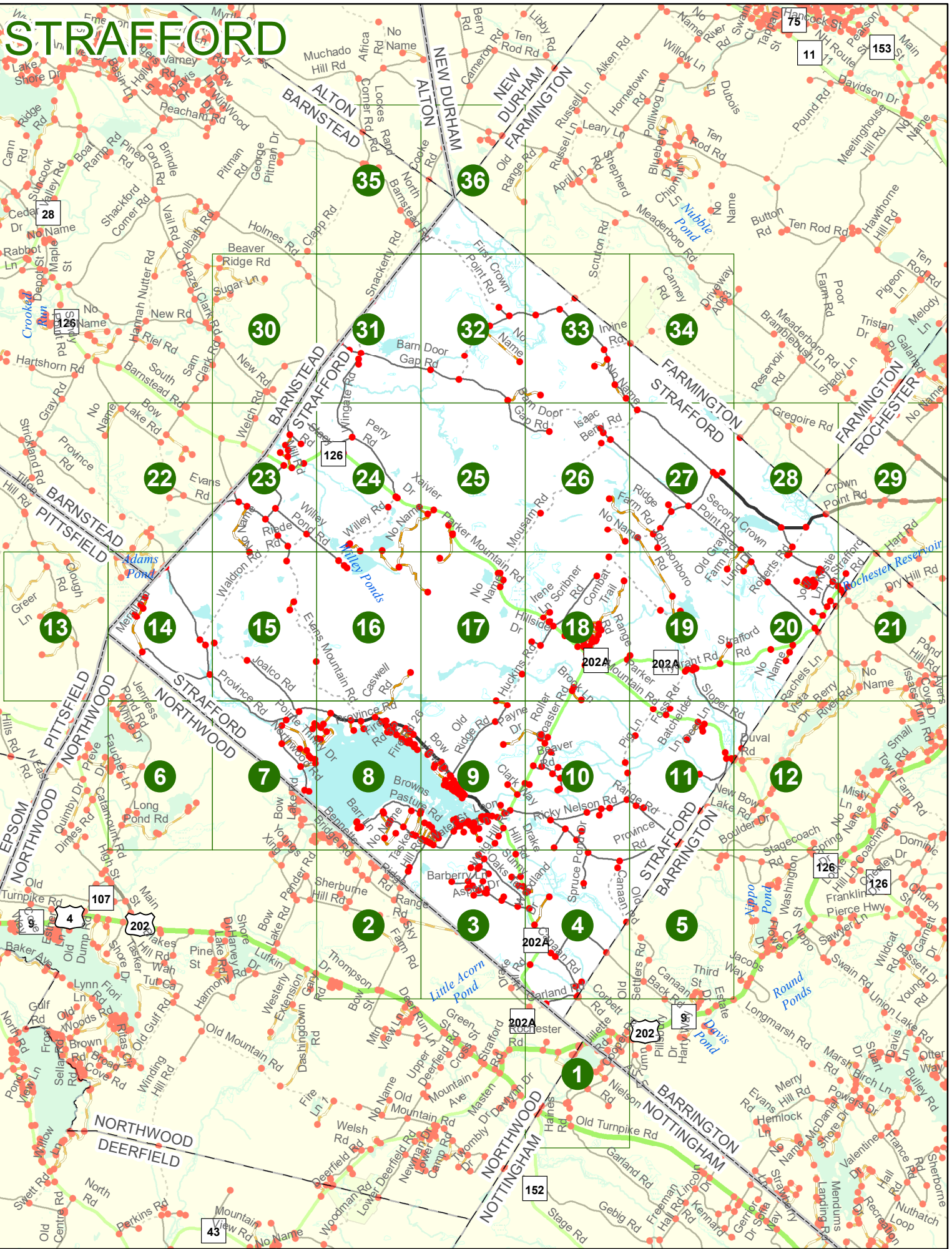

STRAFFORD

Match to Page 4

4

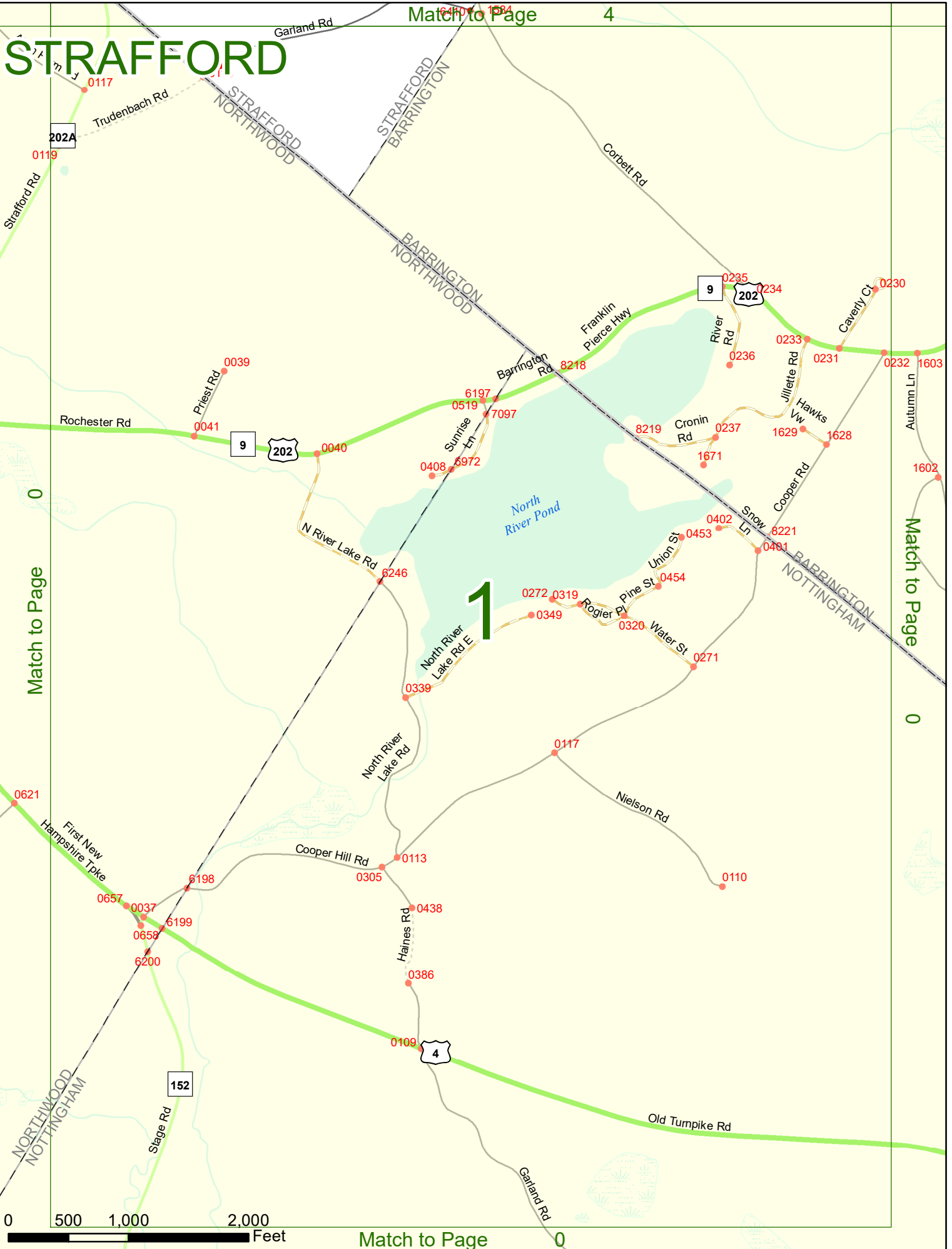

Match to Page 0

0

Match to Page 0

0

0 500 1,000 2,000 Feet

Match to Page 0

0

STRAFFORD

Match to Page 8

8

Knowles Way

0

Match to Page

2

Match to Page

3

STRAFFORD
NORTHWOOD

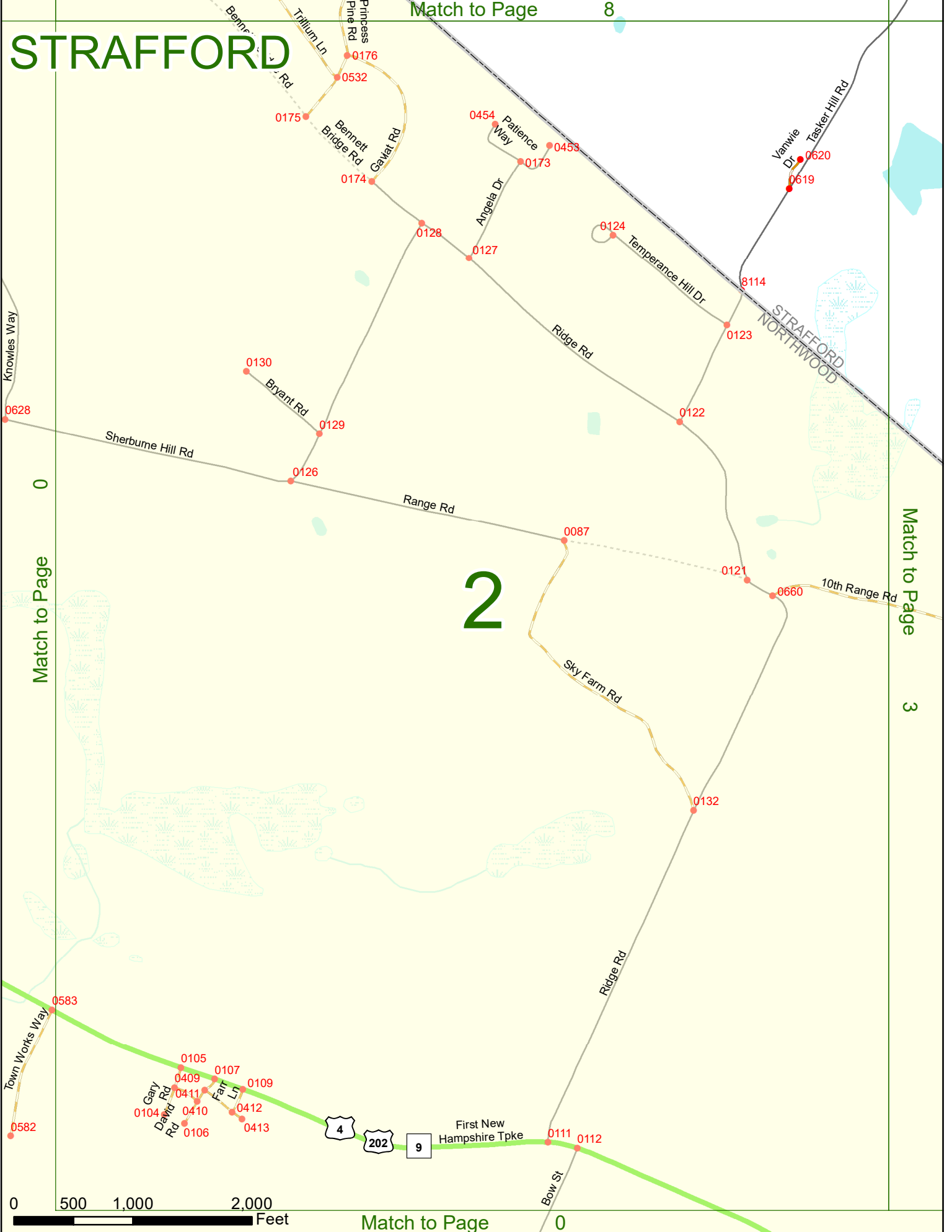

0 500 1,000 2,000 Feet

Match to Page

0

STRAFFORD

Match to Page 9

9

Match to Page 2

2

Match to Page 4

4

3

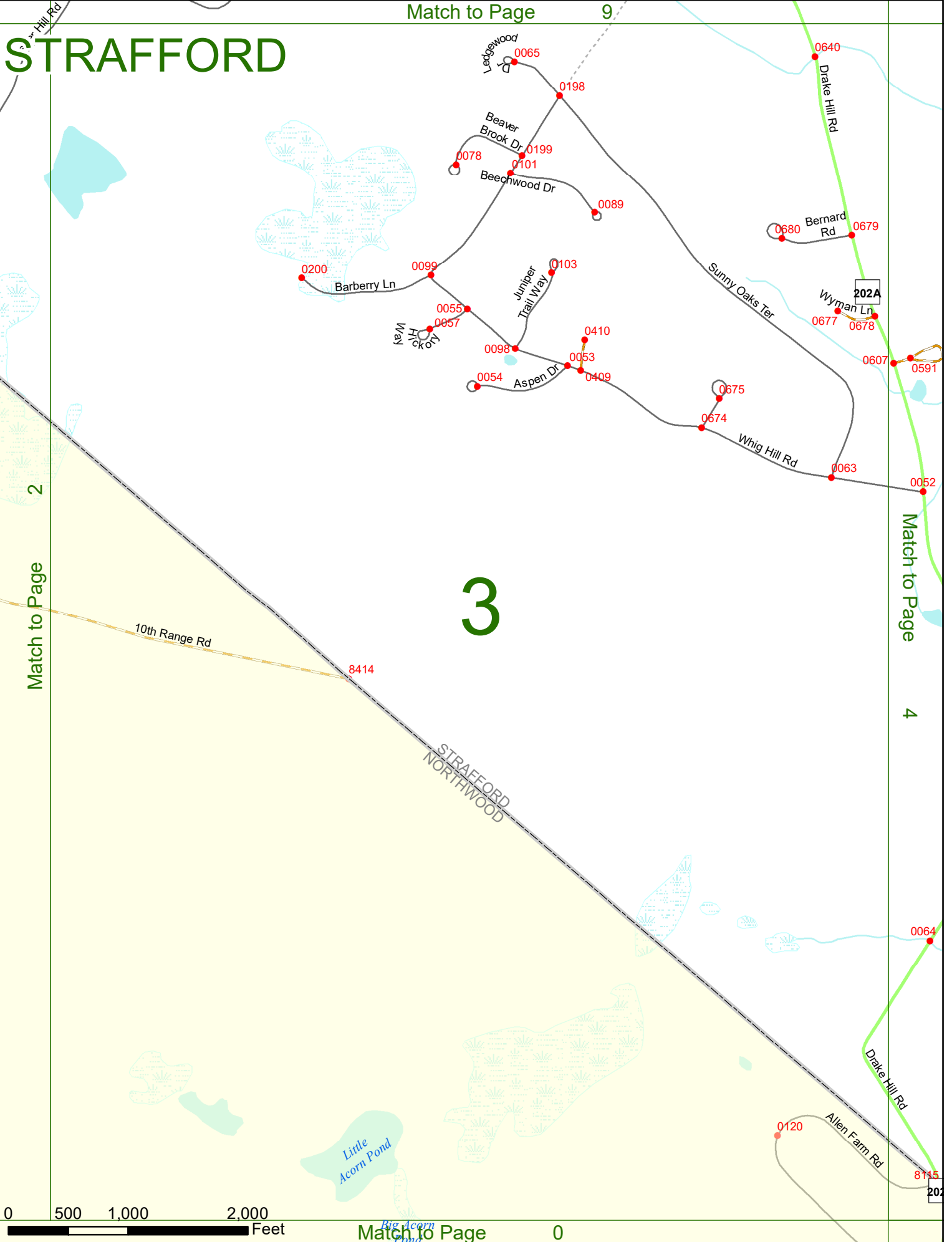

0 500 1,000 2,000 Feet

Match to Page

0

STRAFFORD

Match to Page 10

0070

0062

Province Rd

0060

0697

Spruce Pond Dr

0061

0679

Wyman Ln

0678

0677

0607

0591

Supply Oaks Ter

Drake Hill Rd

0408

Woodland Dr

Spruce Ponds

Old Canaan Rd

Whig Hill Rd

0052

4

Match to Page 3

0407

202A

0051

Back Canaan Rd

0050

0049

STRAFFORD BARRINGTON

6101

Match to Page 5

5

Drake Hill Rd

0064

Canaan Rd

Canaan Back Rd

0047

0048

0047

0047

0047

0047

0047

0047

0047

0047

0047

0047

0047

0047

STRAFFORD NORTHWOOD

0 500 1000 2000 Feet

Match to Page 1

1

6410

6102

1584

Corbett Rd

Garland Rd

Allen Farm Rd

0115

0115

0115

0115

STRAFFORD

Match to Page 11

Stagecoach Rd

Range Rd

Boulder Dr

0526

0539

0525

1557

STRAFFORD
BARRINGTON

4

Match to Page

1100

Old Canaan Rd

1351

1558

Old Settlers Rd

0225

Canaan Back Rd

1563

Match to Page

5

Match to Page

0

0 500 1,000 2,000 Feet

Field St

Third St

1637

0213

0211

0214

Estate Dr

0214

Second St

0216

Franklin
Pierce Hwy

0202

STRAFFORD

STRAFFORD
NORTHWOOD

6

Match to Page 7

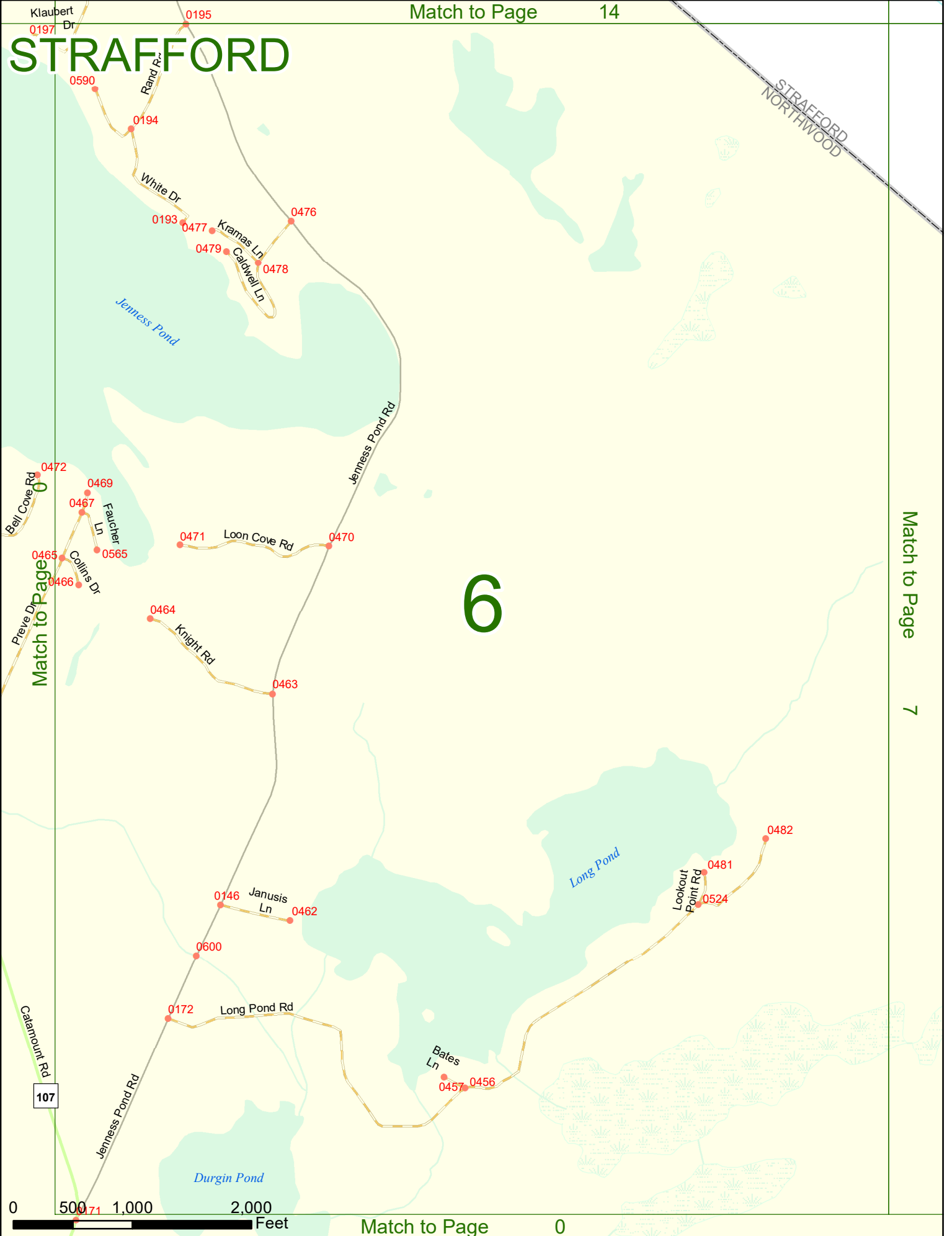

STRAFFORD

6

Match to Page

7

STRAFFORD
NORTHWOOD

Match to Page

8

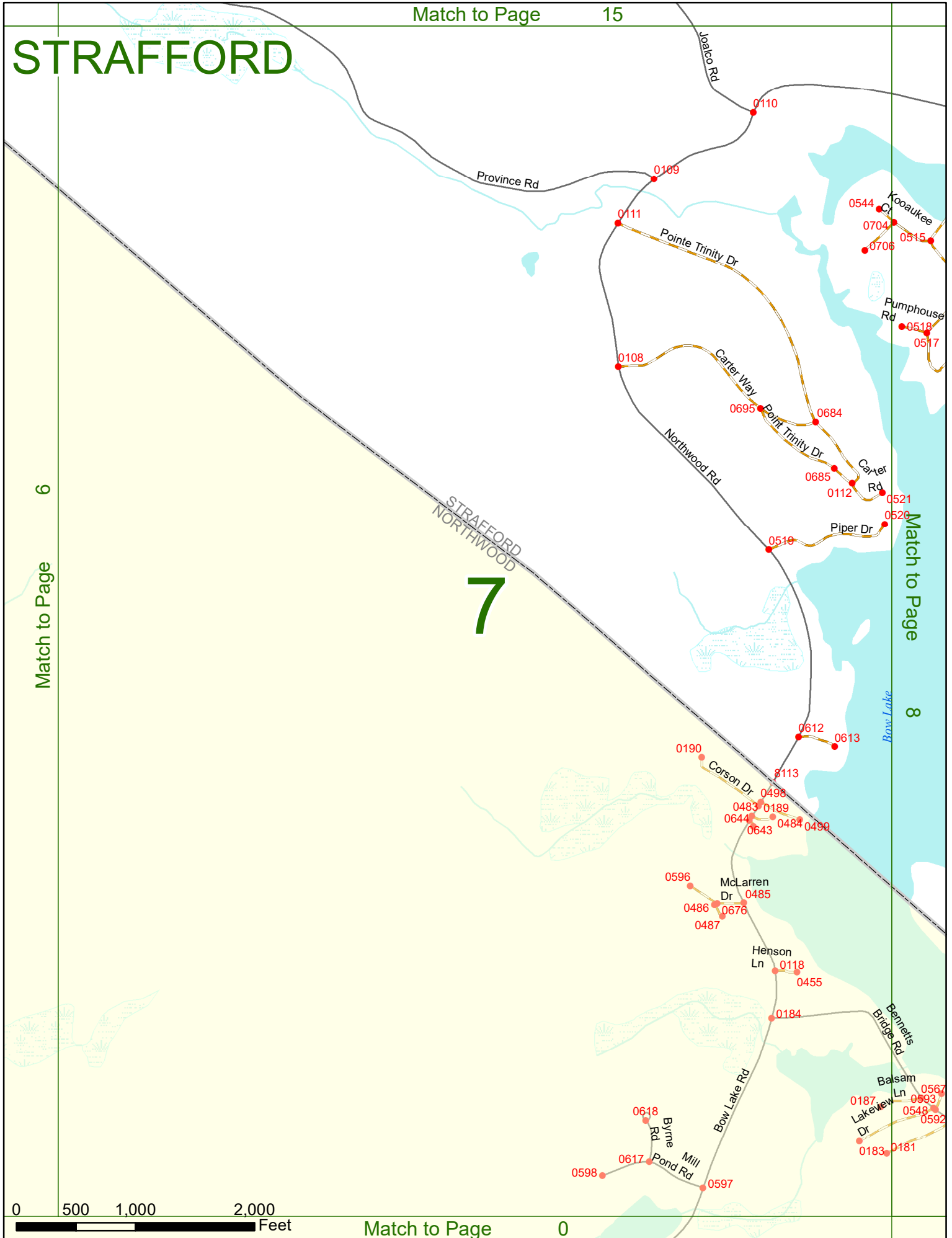
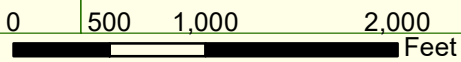

STRAFFORD

Match to Page 17

0588 Goodstein Rd
0587
0556

8

Match to Page

9

Match to Page

10

0 500 1,000 2,000 Feet

Match to Page

3

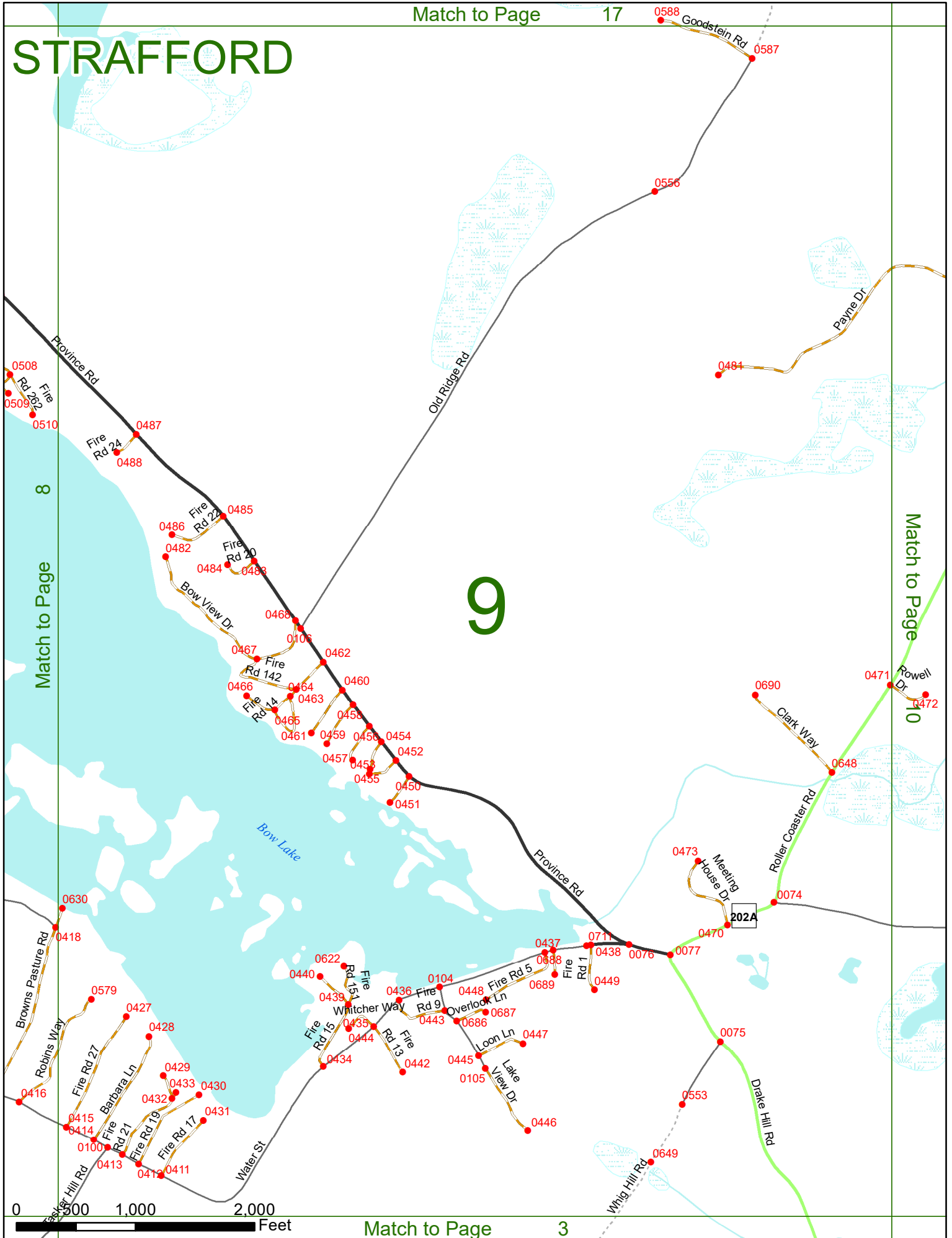

STRAFFORD

Match to Page 18

18

9

Match to Page

10

Match to Page

11

Match to Page

11



Match to Page

0062

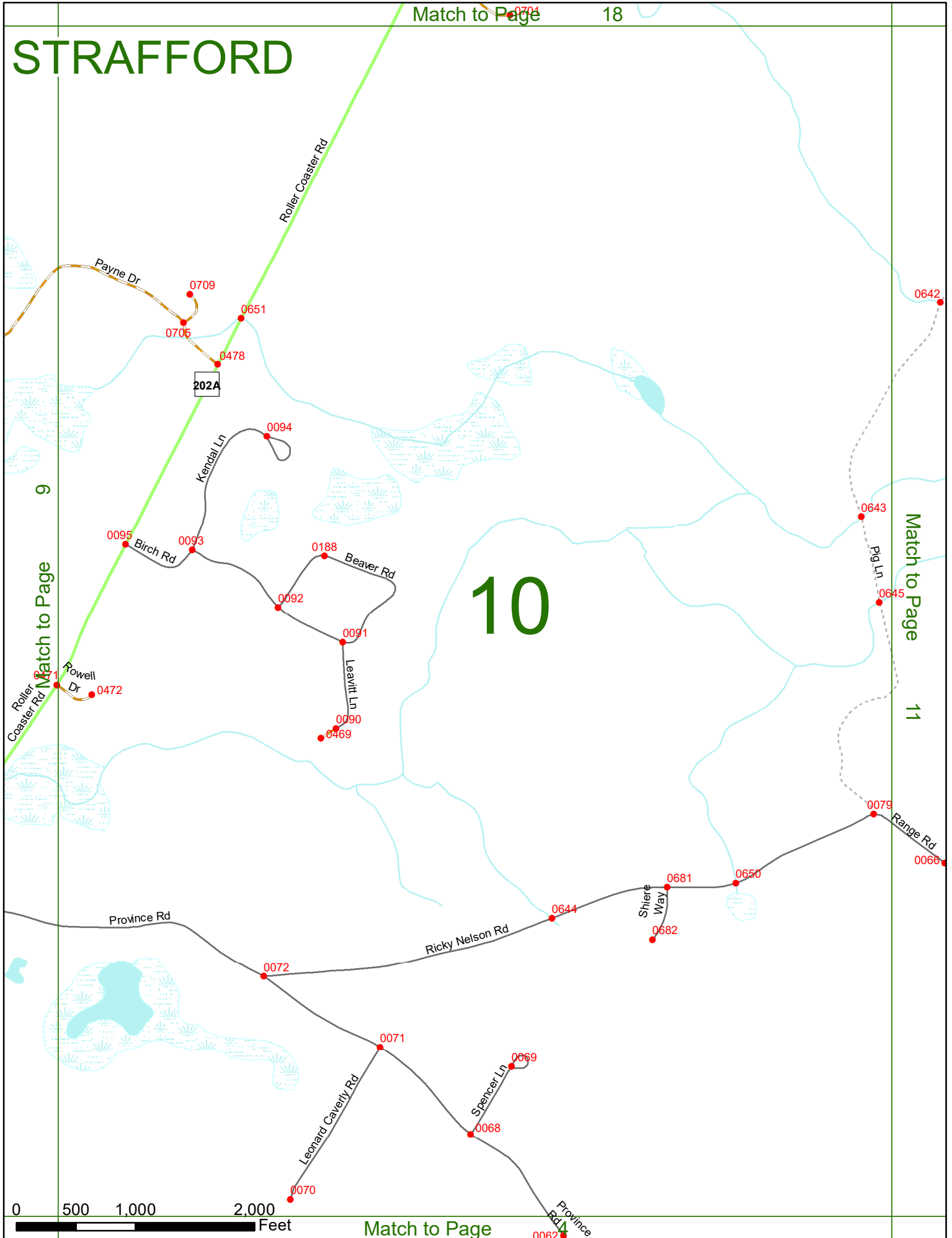

STRAFFORD

Match to Page 19

11

Match to Page 12

Match to Page 5

0 500 1,000 2,000 Feet

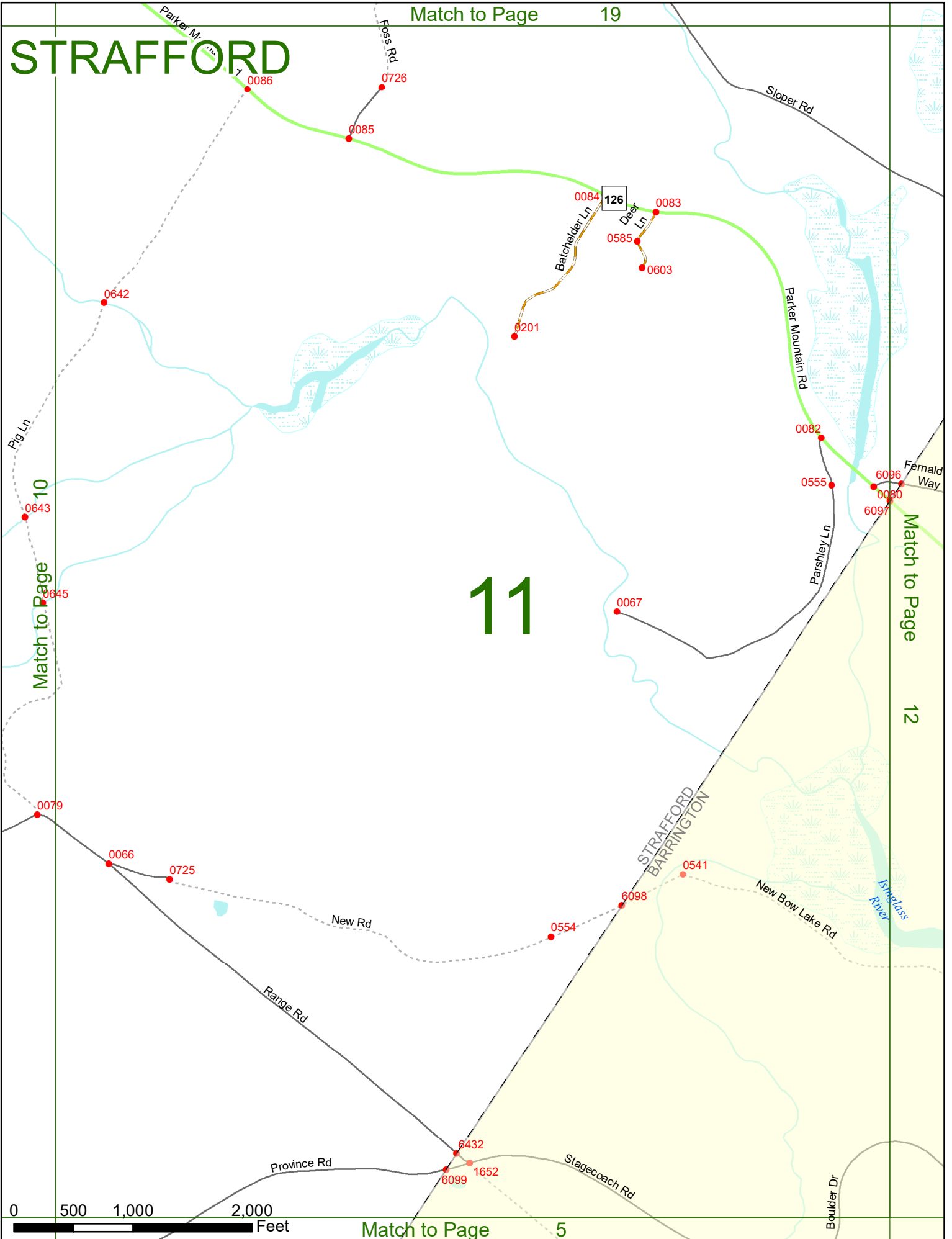

STRAFFORD

Match to Page 20

12

Match to Page 0

Match to Page 11

0

0 500 1,000 2,000 Feet

Match to Page 0

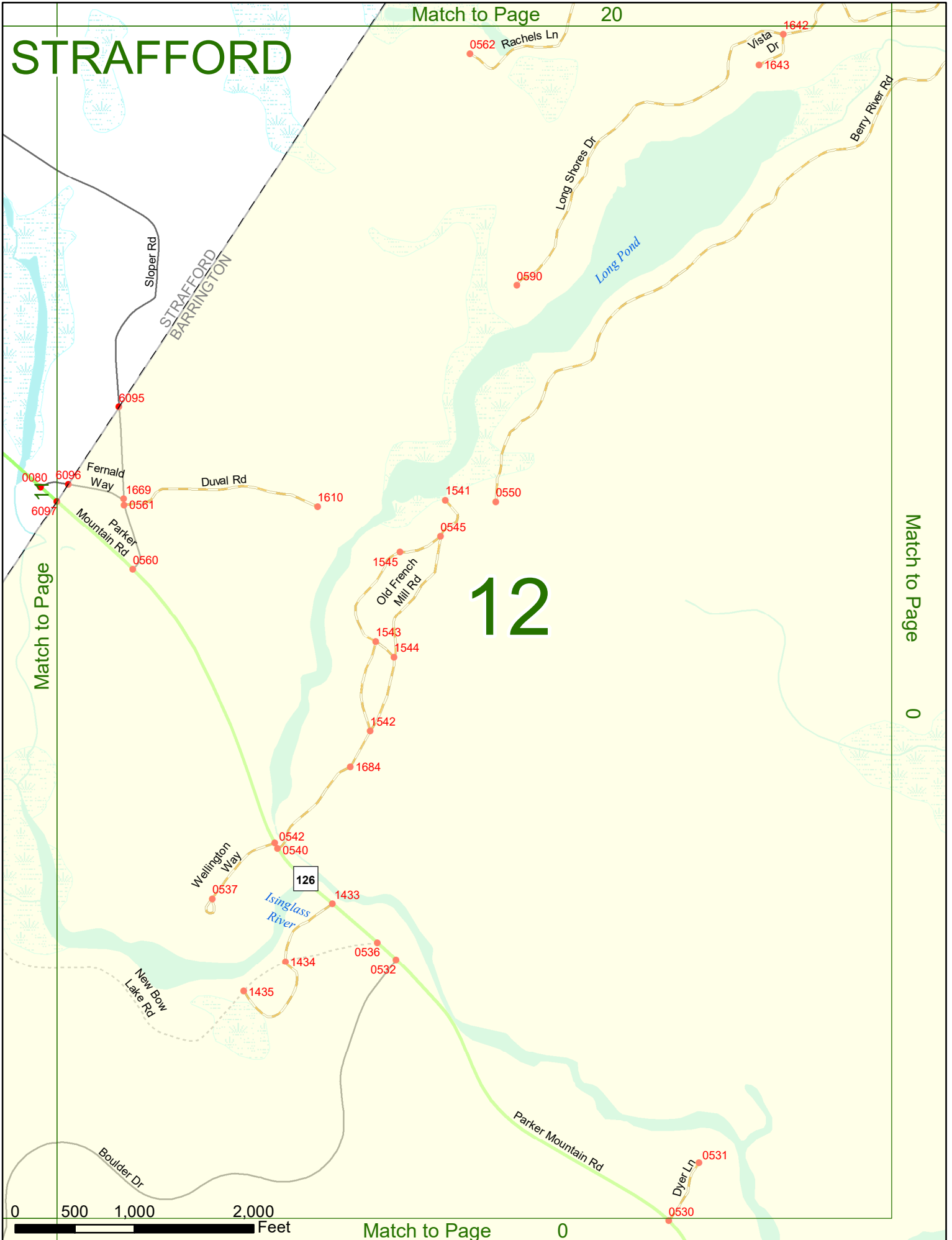

STRAFFORD

Match to Page 0

0

Match to Page

13

Match to Page

14

0 500 1,000 2,000 Feet

Match to Page 0

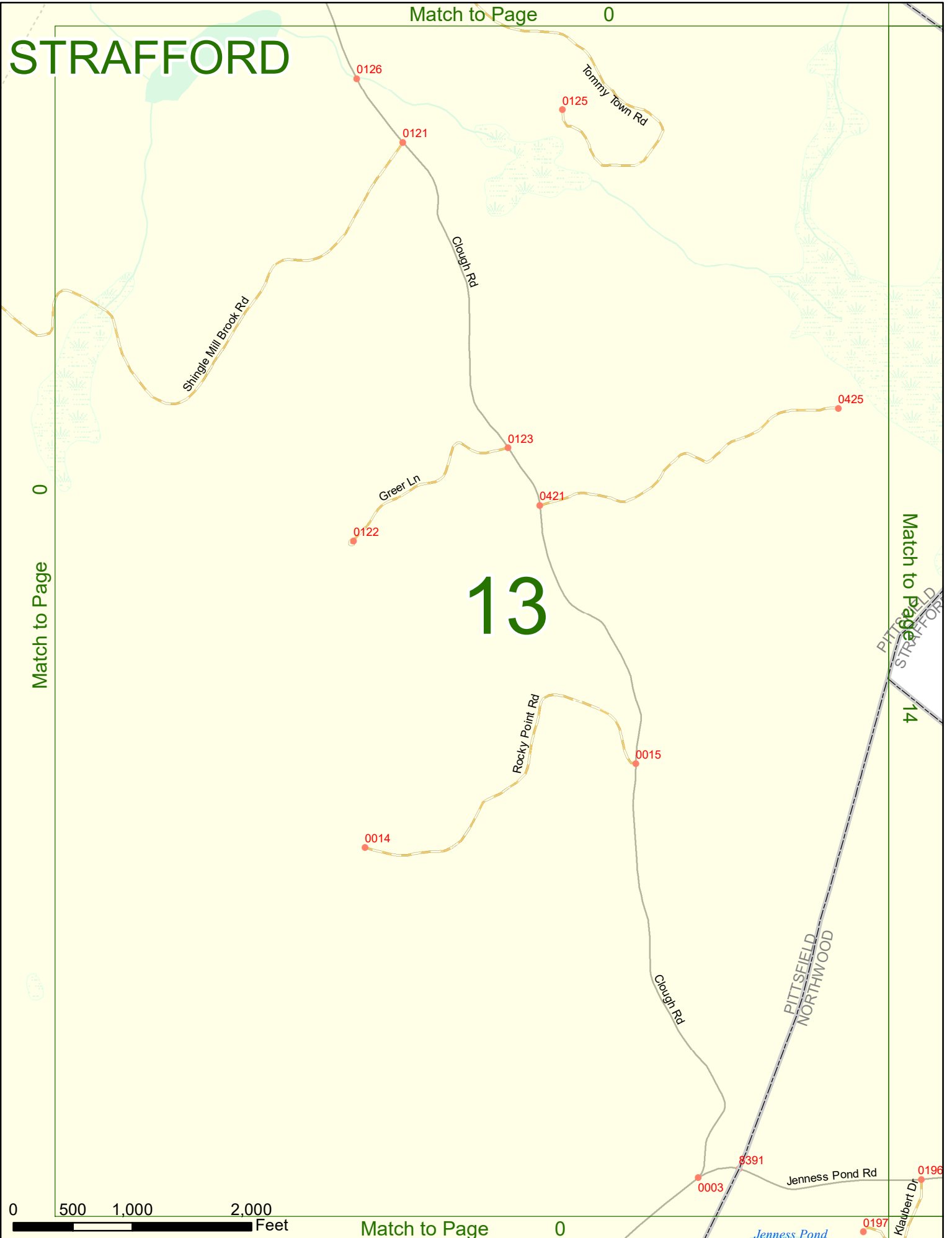

STRAFFORD

Match to Page 22

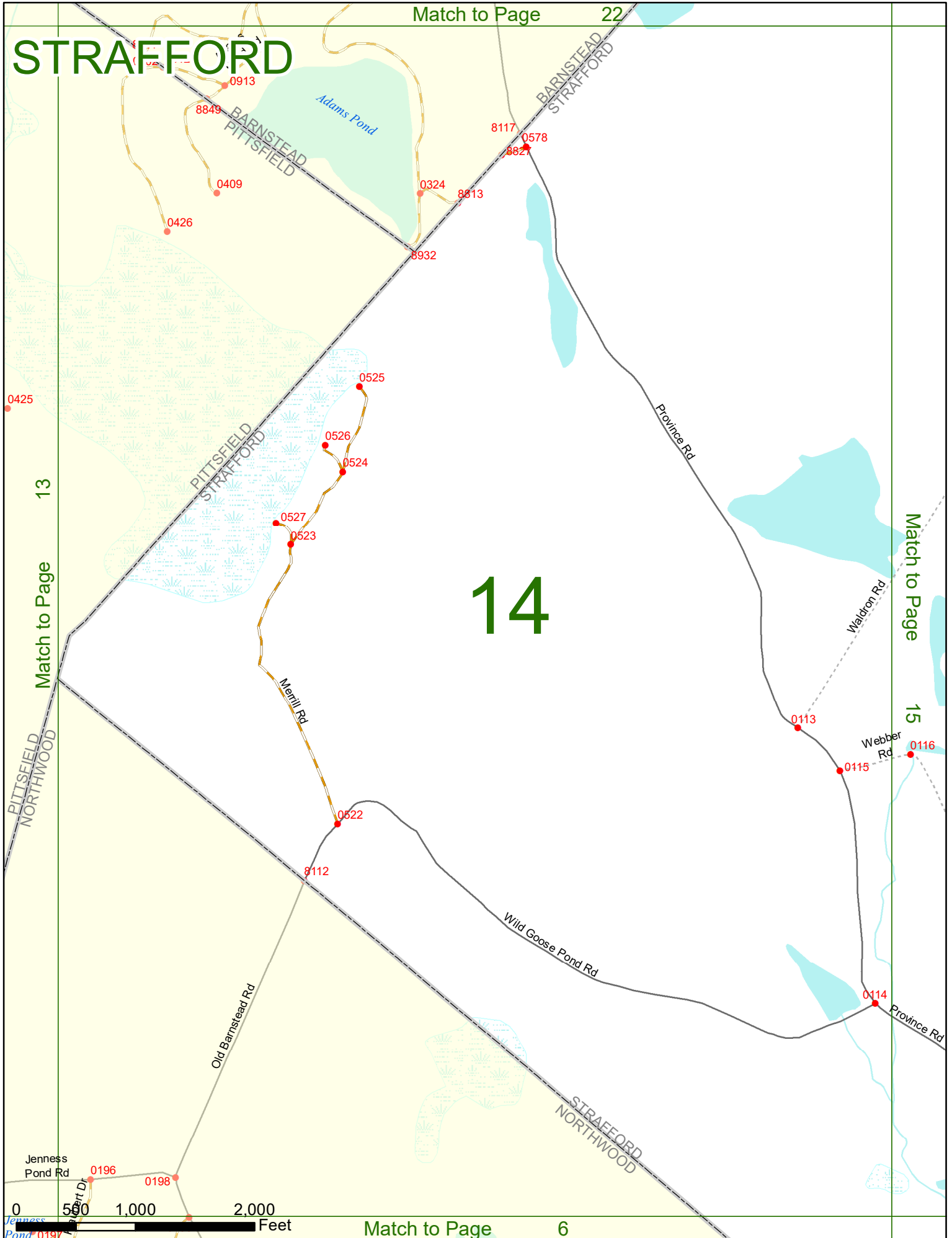

14

13

Match to Page

Match to Page

15

Match to Page

6

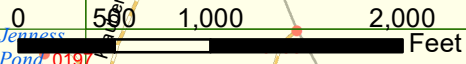

Jenness Pond Rd 0196 0198

Jenness Pond 0197

STRAFFORD

Match to Page

23

14

Match to Page

15

Match to Page

16

0117

0632

0724

0610

0611

0116

0115

0557

0114

Watson Rd

Evans Mountain Rd

Evans Mountain Rd

Weber Rd

Joalco Rd

Province Rd



Match to Page

7

STRAFFORD

Match to Page 24

Wiley Pond Rd
0118

0119
0627

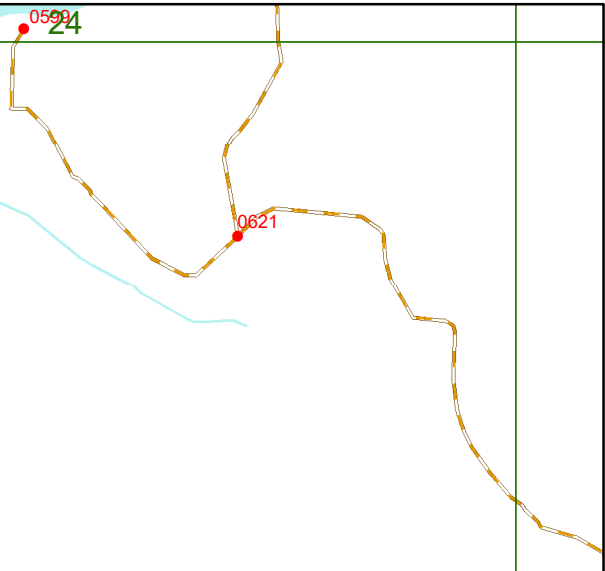
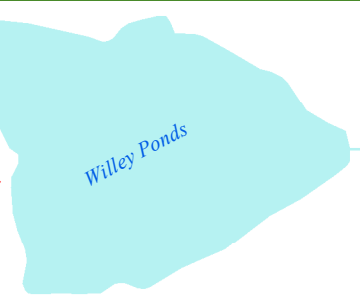

0621

15

Match to Page

16

Match to Page

17



0117

Evans Mountain Rd

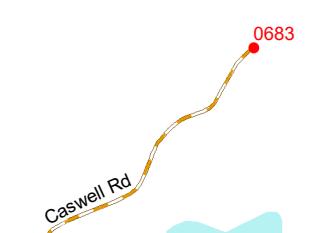

0683

Caswell Rd

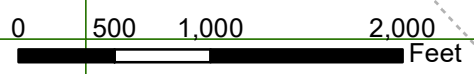

Match to Page



8

STRAFFORD

Match to Page 25

Match to Page 16

Match to Page 18

17

Match to Page 9

0 500 1,000 2,000 Feet

0588 Goodstein Rd

Huckins Rd

Parker Mountain Rd

Mousam Rd

0600

0125

0124

0723

0123

126

0120

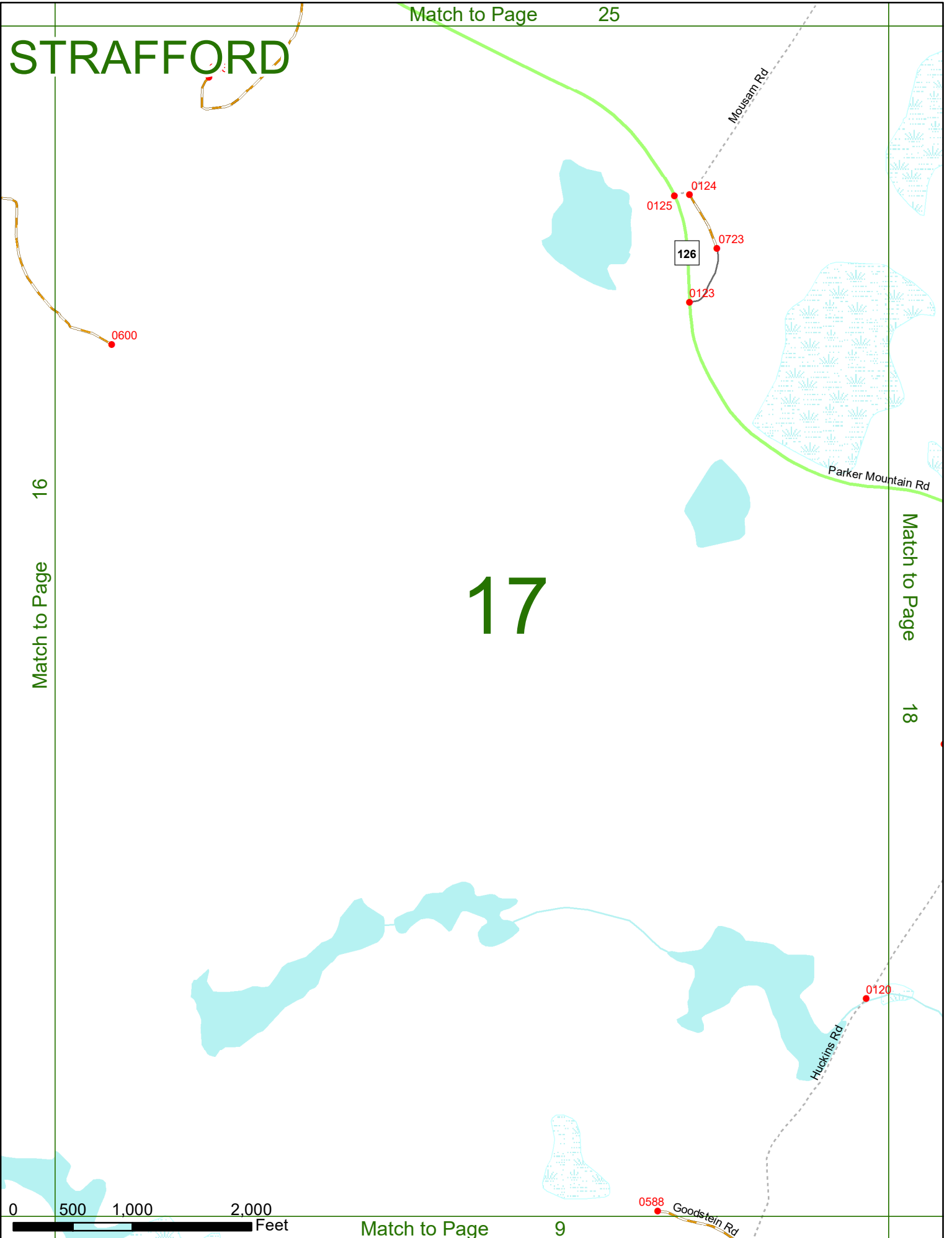

STRAFFORD

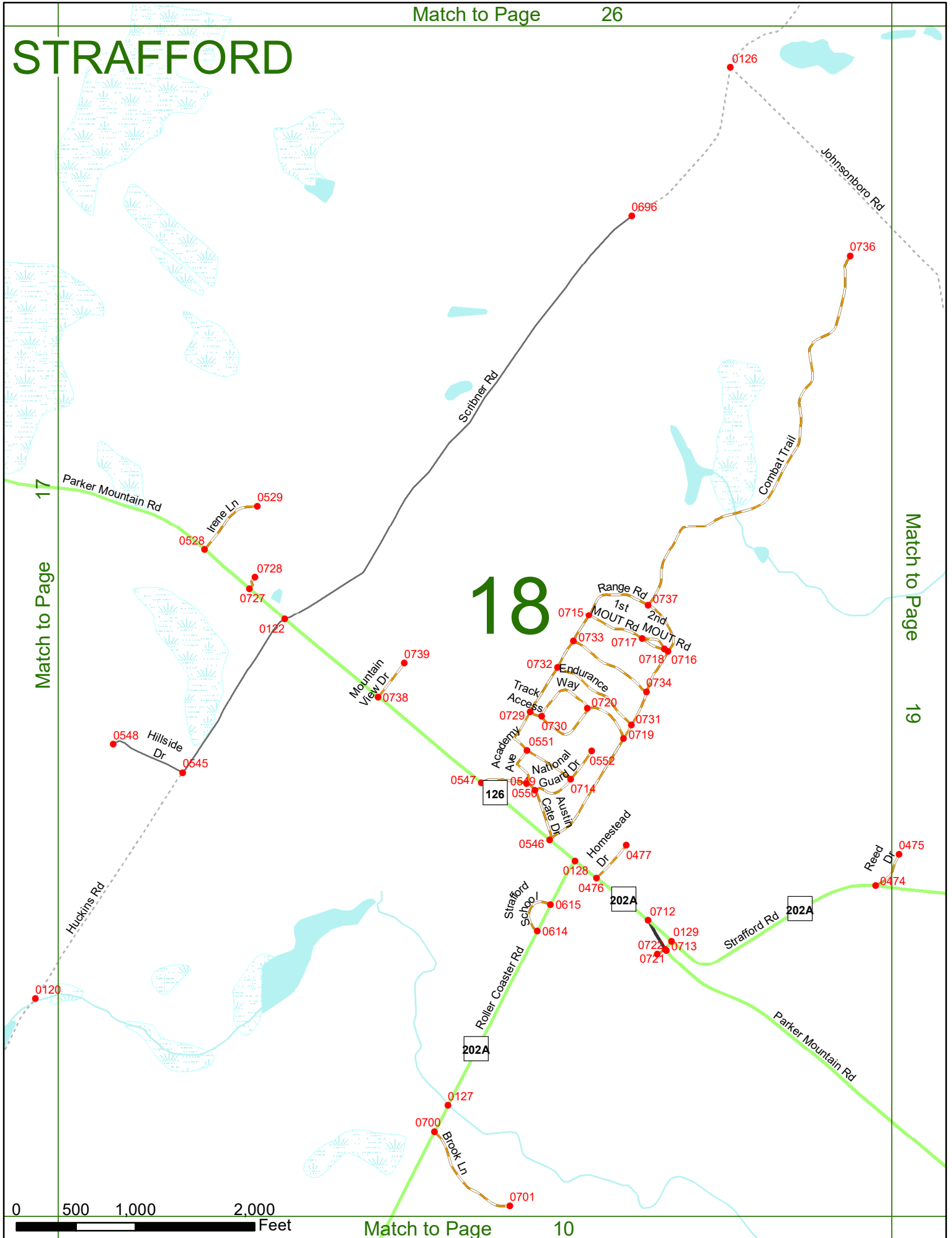

Match to Page 17

Match to Page 19

18

0 500 1,000 2,000 Feet

Match to Page 10

STRAFFORD

18

Match to Page

Match to Page 20

19

Johnsonboro Rd

Old Gray Farm Rd

0691

0736

0626

0647

0570

0571

0625

0589

0136

0741

Roberts Rd

0475

0474

Reed Dr

Strafford Rd

Strafford Rd

0137

202A

0580

0134

0133

0130

0132

Foss Rd

Sloper Rd

126

Parker Mountain

0 500 1,000 2,000 Feet

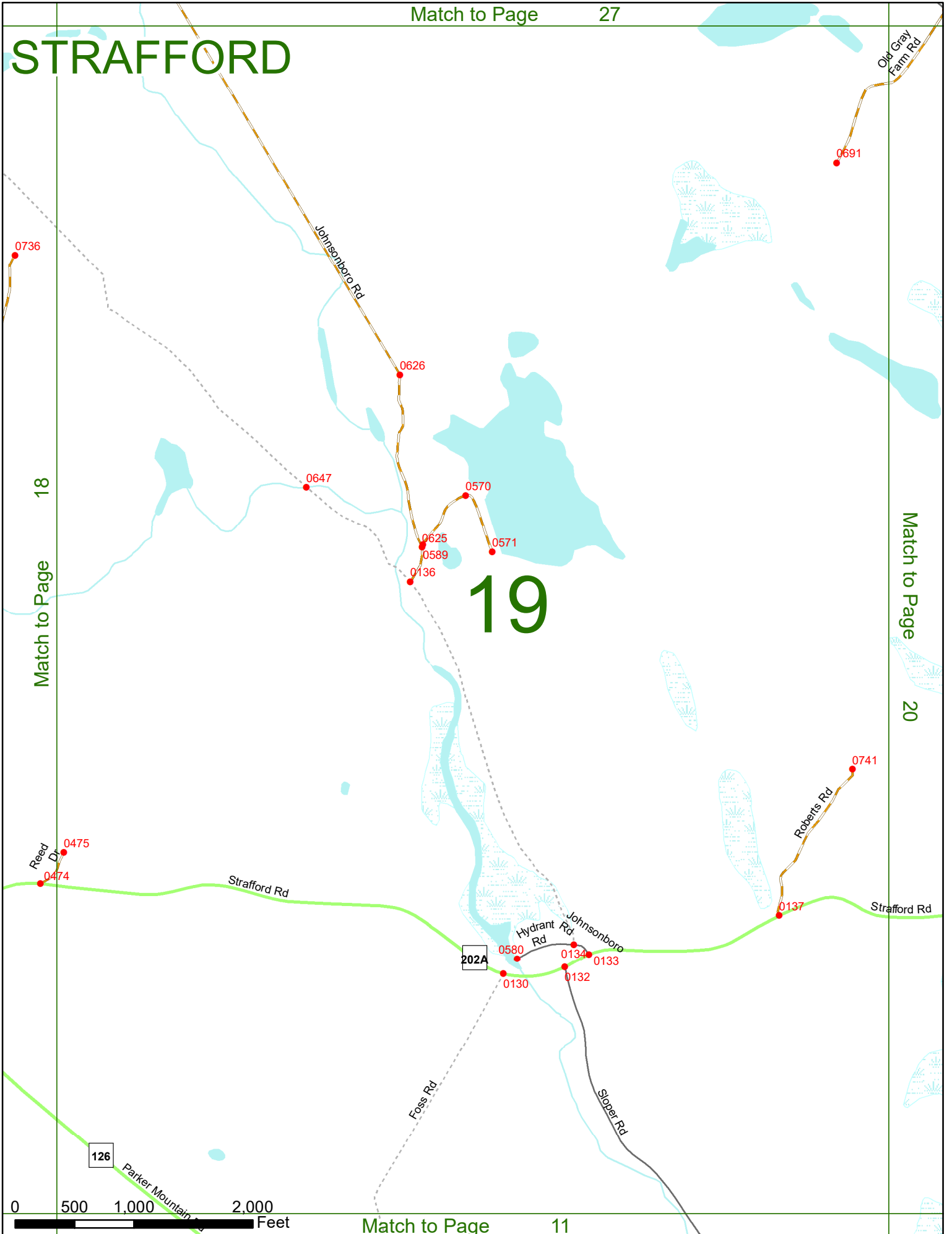

STRAFFORD

Match to Page 28

19

Match to Page

20

Match to Page

21

0 500 1,000 2,000 Feet

Match to Page 12

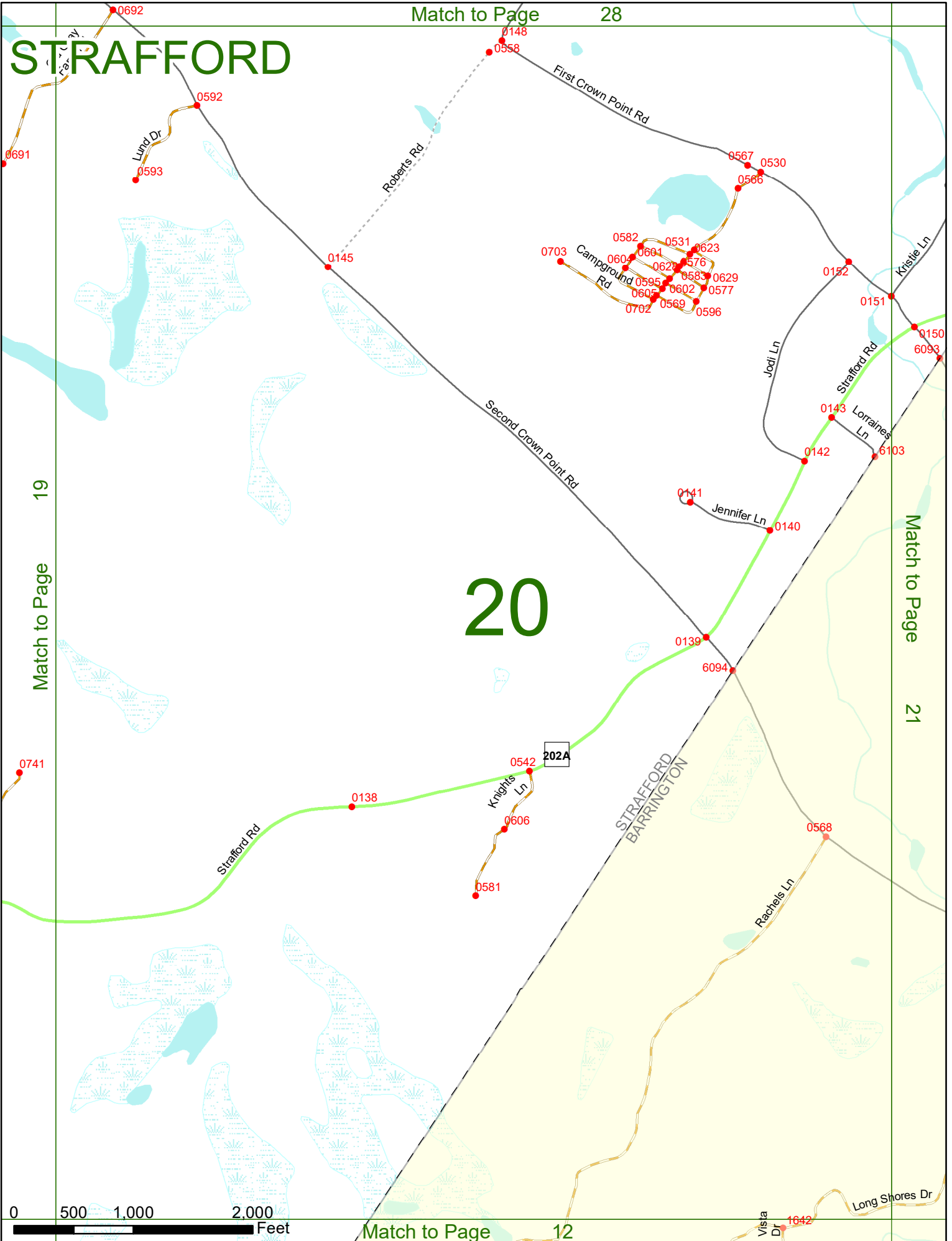

STRAFFORD

Match to Page 29

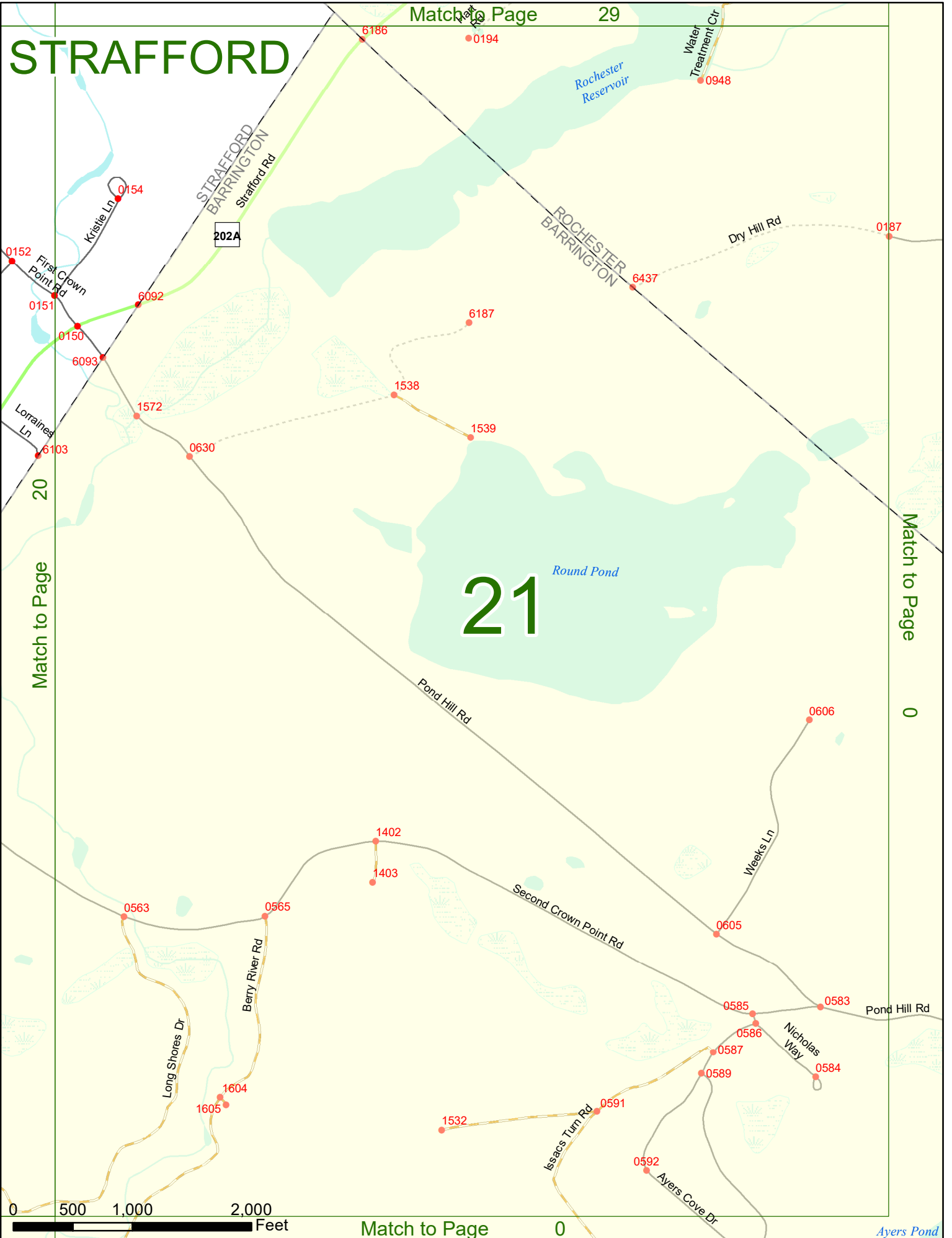

Match to Page

Match to Page

0

Match to Page

0

Ayers Pond

0 500 1,000 2,000 Feet

STRAFFORD

Match to Page 0

Match to Page 0

Match to Page 23

22

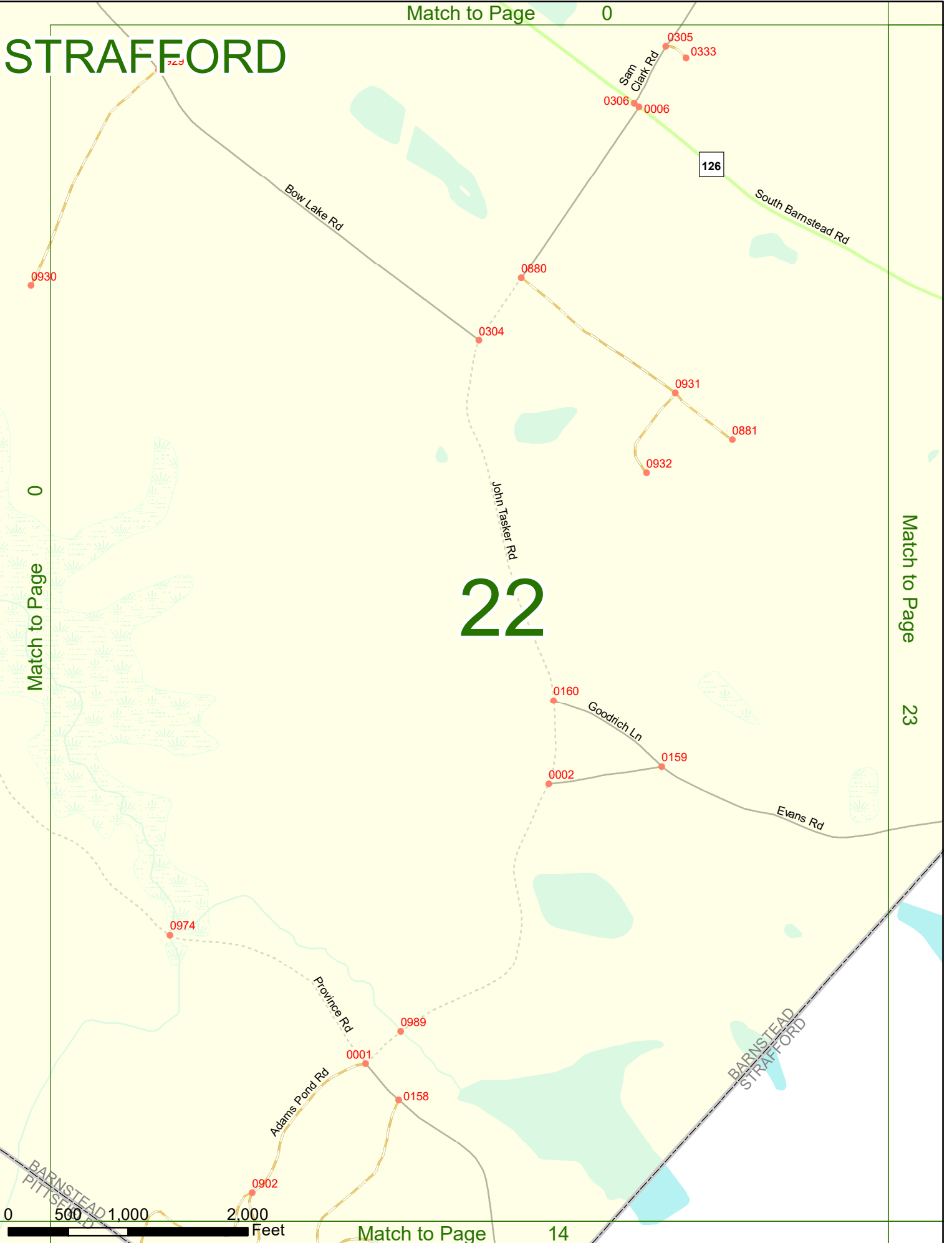

0 500 1,000 2,000 Feet

Match to Page 14

STRAFFORD

Match to Page

30

22

Match to Page

23

Match to Page

24

0 500 1,000 2,000 Feet

Match to Page

15

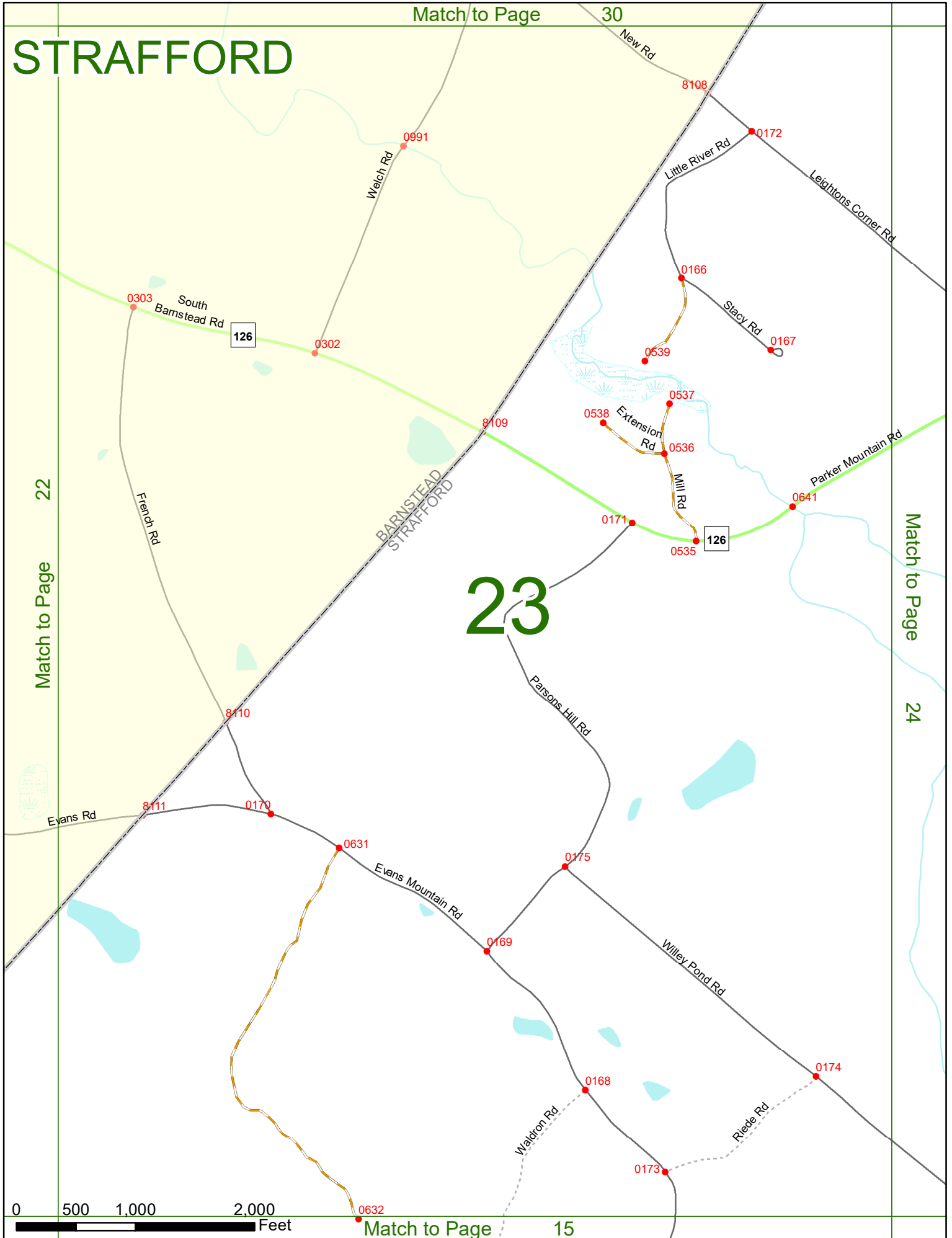

STRAFFORD

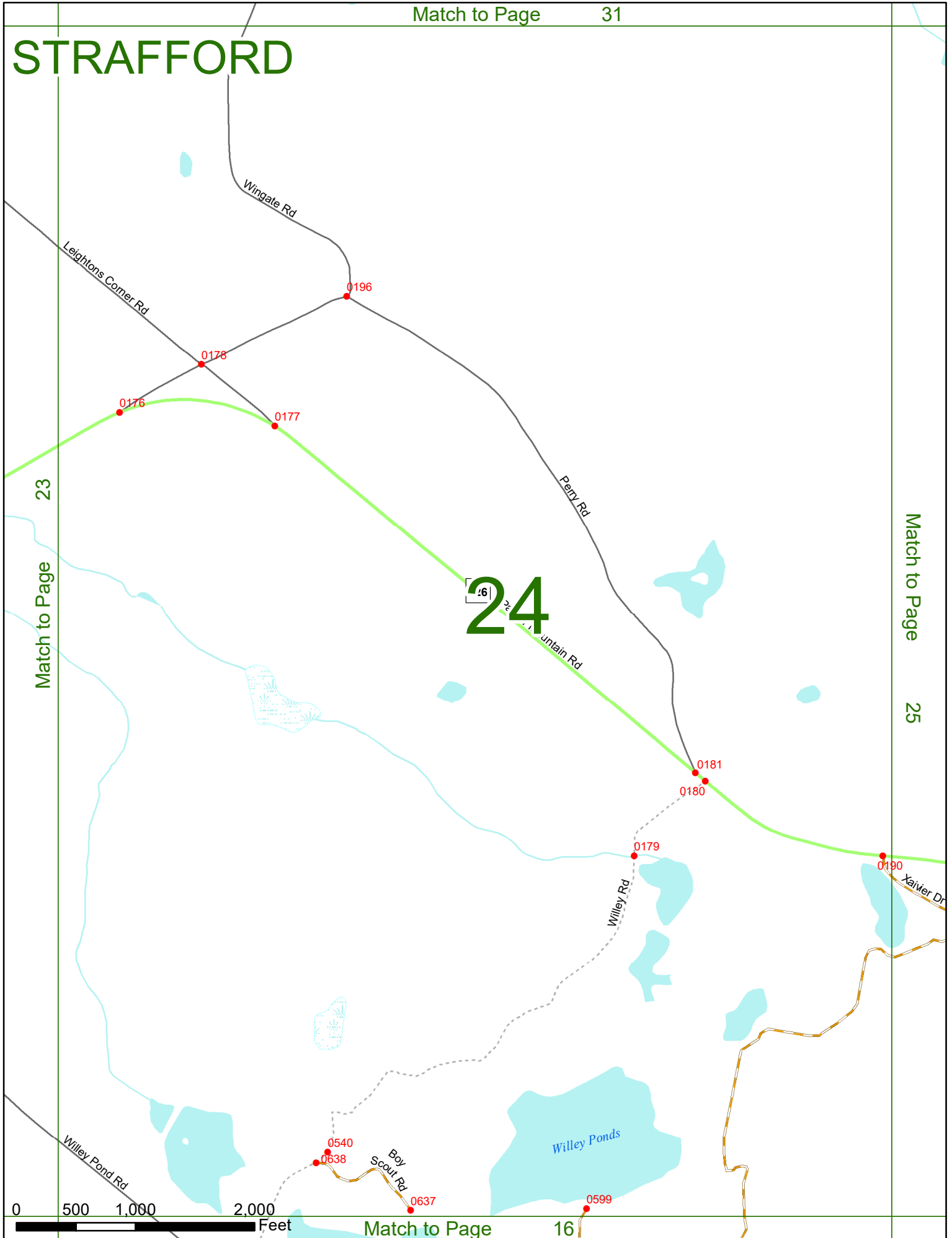

23

Match to Page

24

Match to Page

25

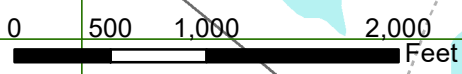

Match to Page 16

STRAFFORD

24

Match to Page

Match to Page

26

25

0598

Barn Door Gap Rd

0190

0189

0191

Parker Mountain Rd

126

0708

0707

0636

Mousam Rd

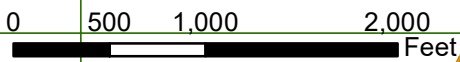

STRAFFORD

25

Match to Page

Match to Page

27

26

Barn Door Gap Rd

Second Crown Point Rd

Isaac Berry Rd

0562

0561

0164

0694

0163

Mousam Rd

0165

0131

Ridge Farm Rd

0608

0609

Scribner Rd



STRAFFORD

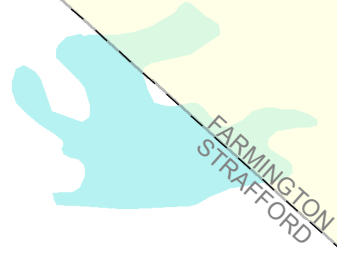

FARMINGTON STRAFFORD

Isaac Berry Rd

First Crown Point Rd

6040

26

Match to Page

27

Second Crown Point Rd

Reservoir Rd

0159 0560 0699

Match to Page

28

Cross Rd

0180

0633

0634

0634

0634

0559

0146

0532

0609

0609

0693

Ridge Farm Rd

Scribner Rd

Mohawk Trail Way

Johnsonboro Rd

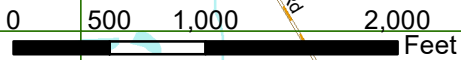

STRAFFORD

Match to Page 0

27

Match to Page

Match to Page

29

28

Rochester Reservoir

0002

Reservoir Rd

0001

Gregoire Rd

0003

Sheepboro Rd

FARMINGTON STRAFFORD

FARMINGTON ROCHESTER

6039

ROCHESTER STRAFFORD

Crown Point Rd

6104

First Crown Point Rd

0147

0156

Roberts Rd

0157

0148

Second Crown Point Rd
Palm Rd

0692



Match to Page 20

STRAFFORD

Match to Page 0

28

Match to Page

Match to Page

0

29

0 500 1,000 2,000 Feet

Match to Page

21

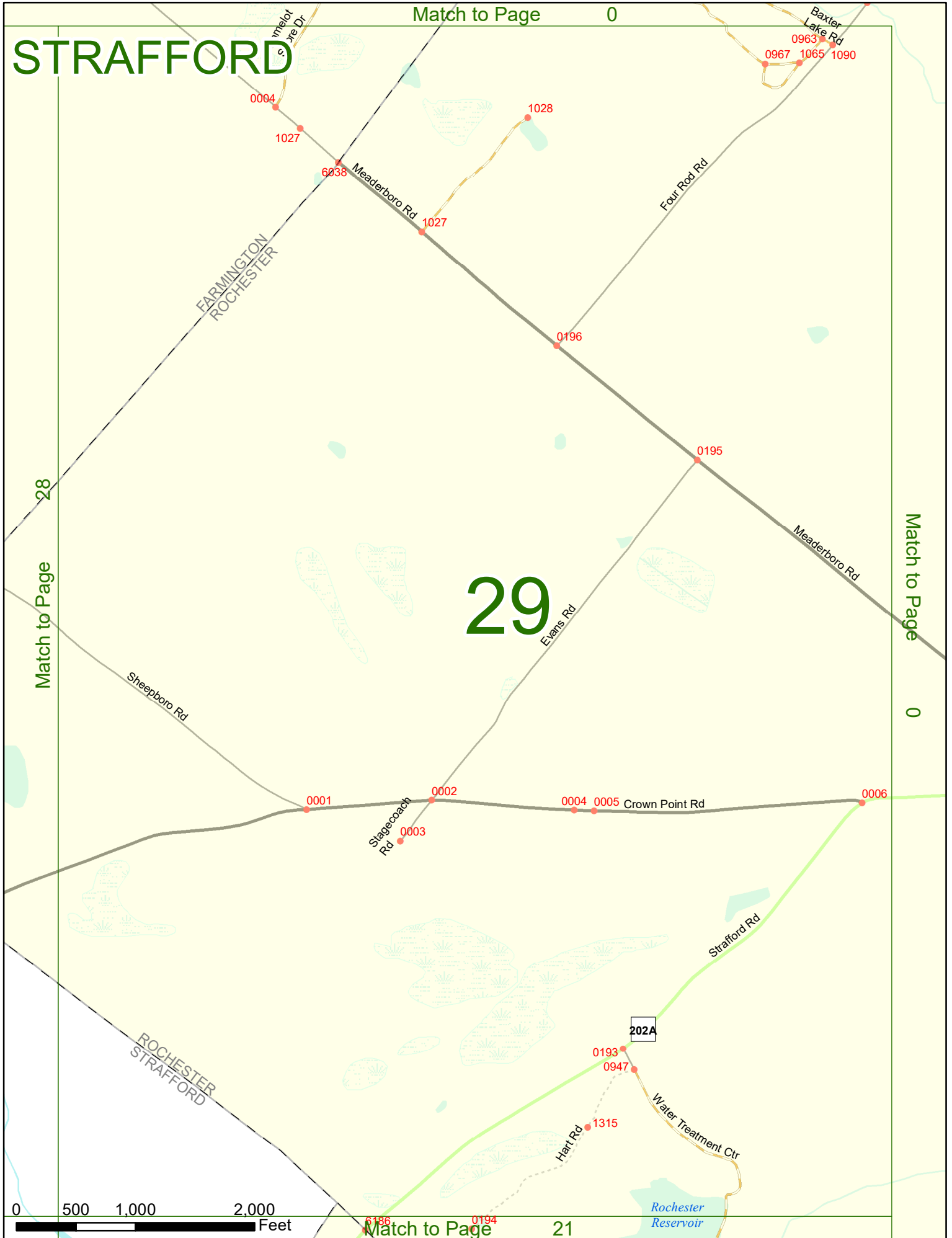

STRAFFORD

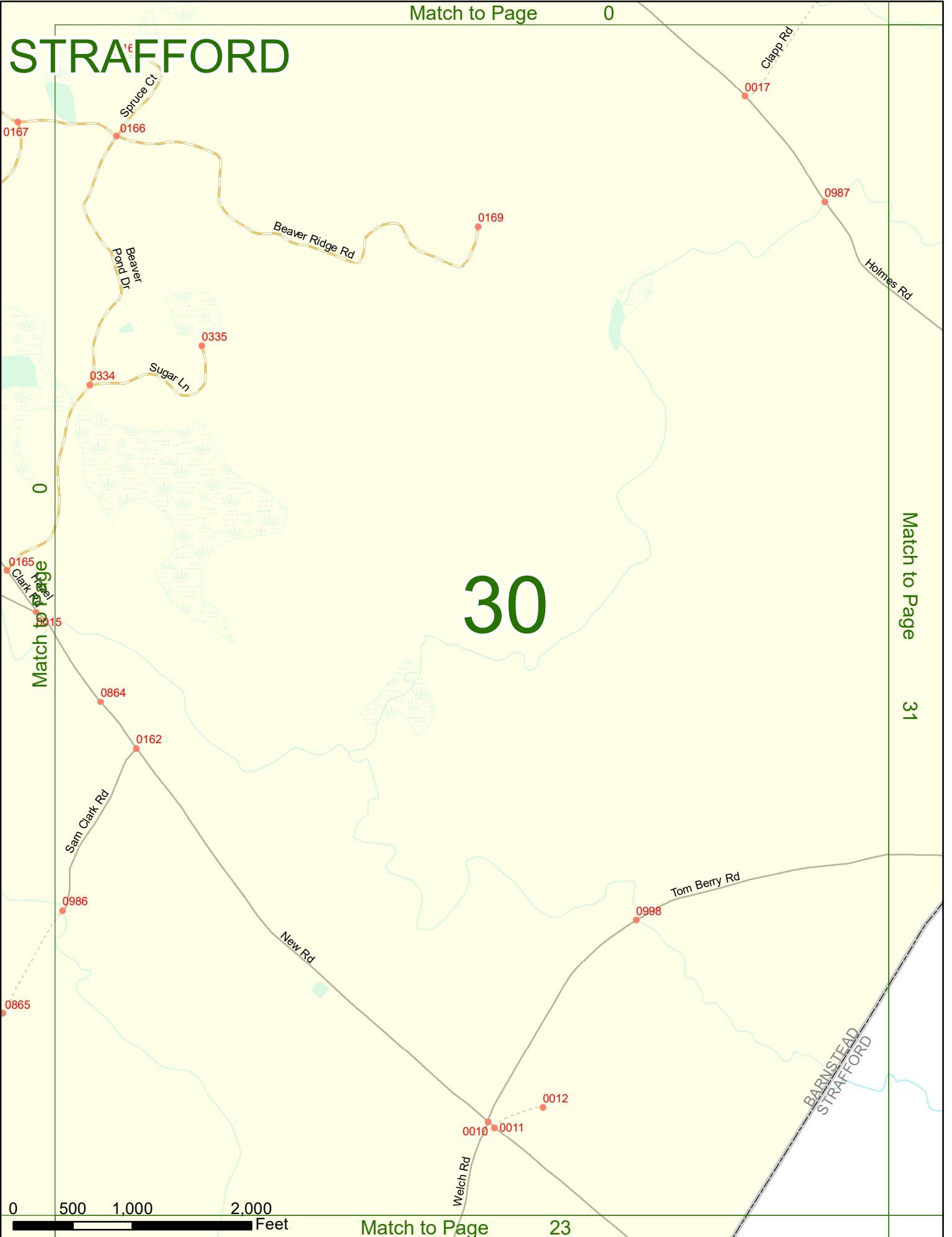

Match to Page

Match to Page 31

30

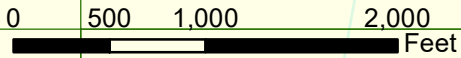

BARNSTEAD
STRAFFORD

STRAFFORD

Match to Page 30

Match to Page 32

31

BARNSTEAD
STRAFFORD

Snackery Rd

Holmes Rd

8107

8105

0195

0194

8106

Tom Berry Rd

Barn Door Gap Rd

0533

0534

Theobald Ln

Wingate Rd

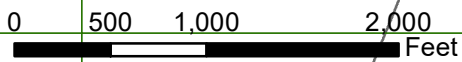

STRAFFORD

Match to Page 36

FARMINGTON
STRAFFORD

31

Match to Page

32

Match to Page

33

First Crown Point Rd

Little Niagara Rd

Barn Door Gap Rd

0193

0192

0646

0182

0563

0564

0184

0183

0598

0 500 1,000 2,000 Feet

Match to Page

25

STRAFFORD

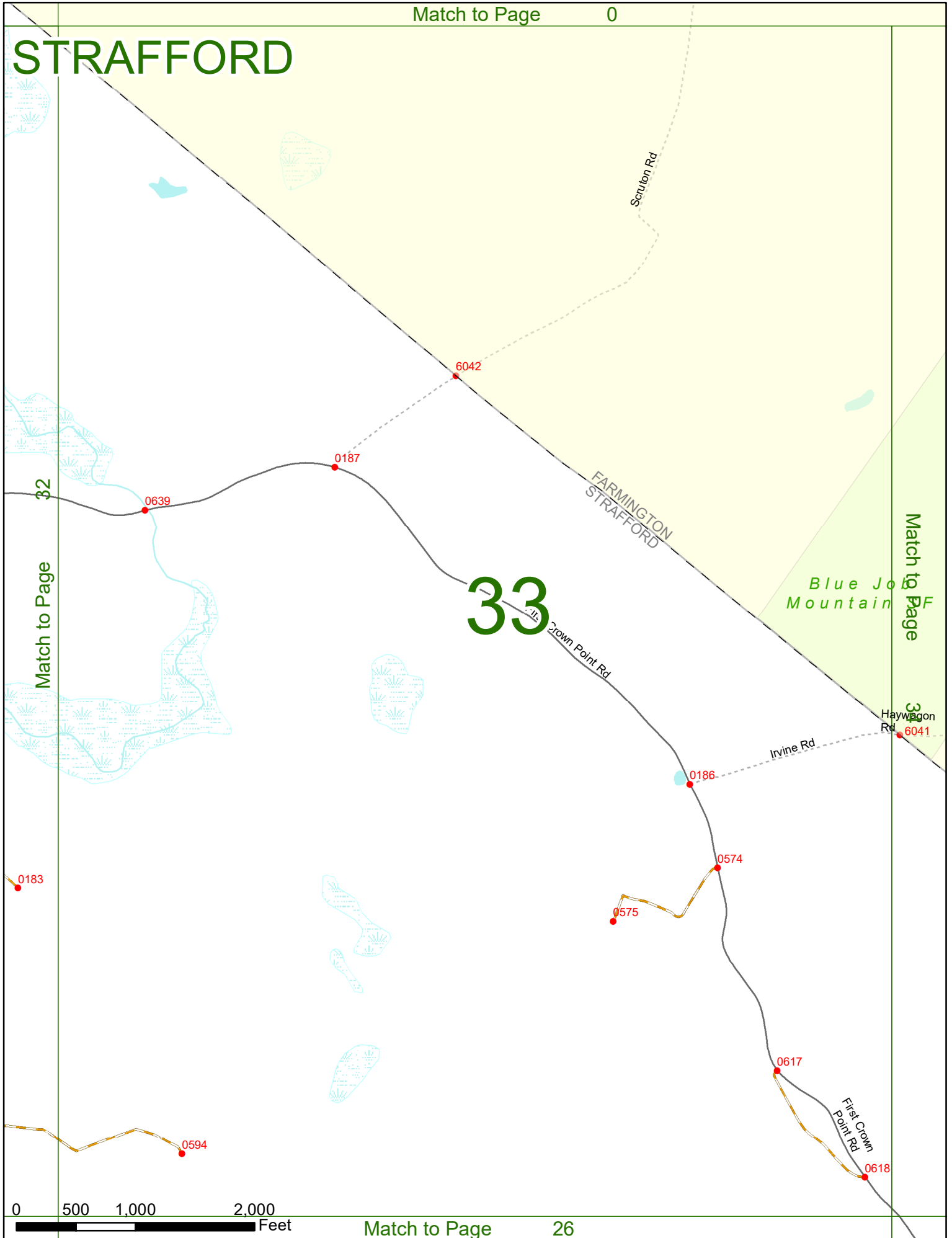

Match to Page 32

Match to Page 33

33



STRAFFORD

Match to Page 0

33

Match to Page

Blue Job Mountain SF

34

Match to Page

0

Irvine Rd 6041

0031

0036

Meaderboro Rd

0575

0574

0034

0033

0035

Driveway A063

Haywagon Rd

0966

0030

Canney Rd

0029

Sheepboro Rd

FARMINGTON
STRAFFORD

0618
First Cow
Road

0 1,000 2,000 Feet

Match to Page 27

STRAFFORD

Match to Page 0

Lockes Corner Rd

6011

ALTON
BARNSTEAD

North Barnstead Rd

Rand Rd

0120

0121

0897

0896

35

North Barnstead Rd

0874

Clapp Rd

Match to Page

36

Cooke Rd

0124

0164

8104

Shackerty Rd

BARNSTEAD
STRAFFORD

0 500 1,000 2,000 Feet

Match to Page 31

STRAFFORD

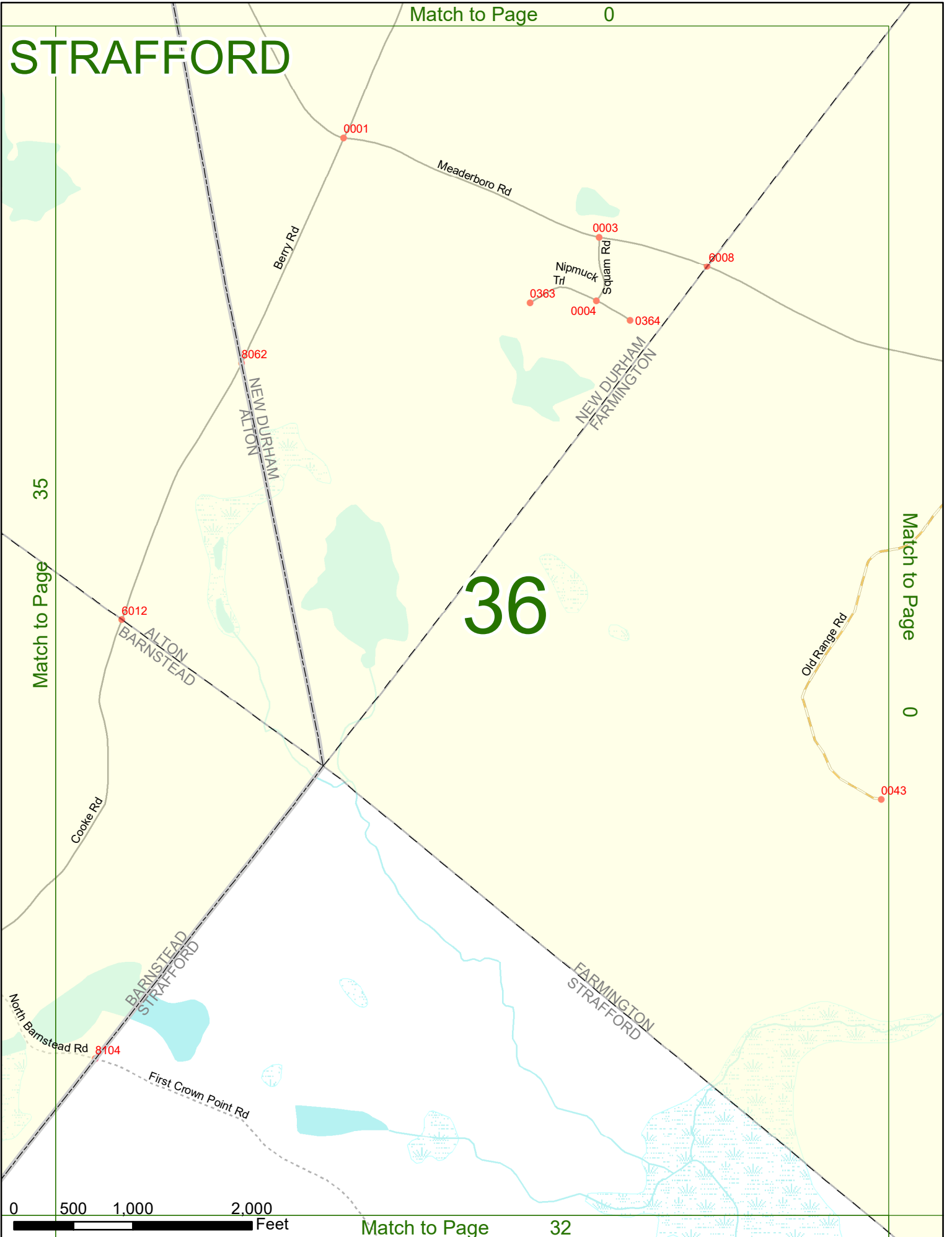

36